

# Select Mira Drawer Components

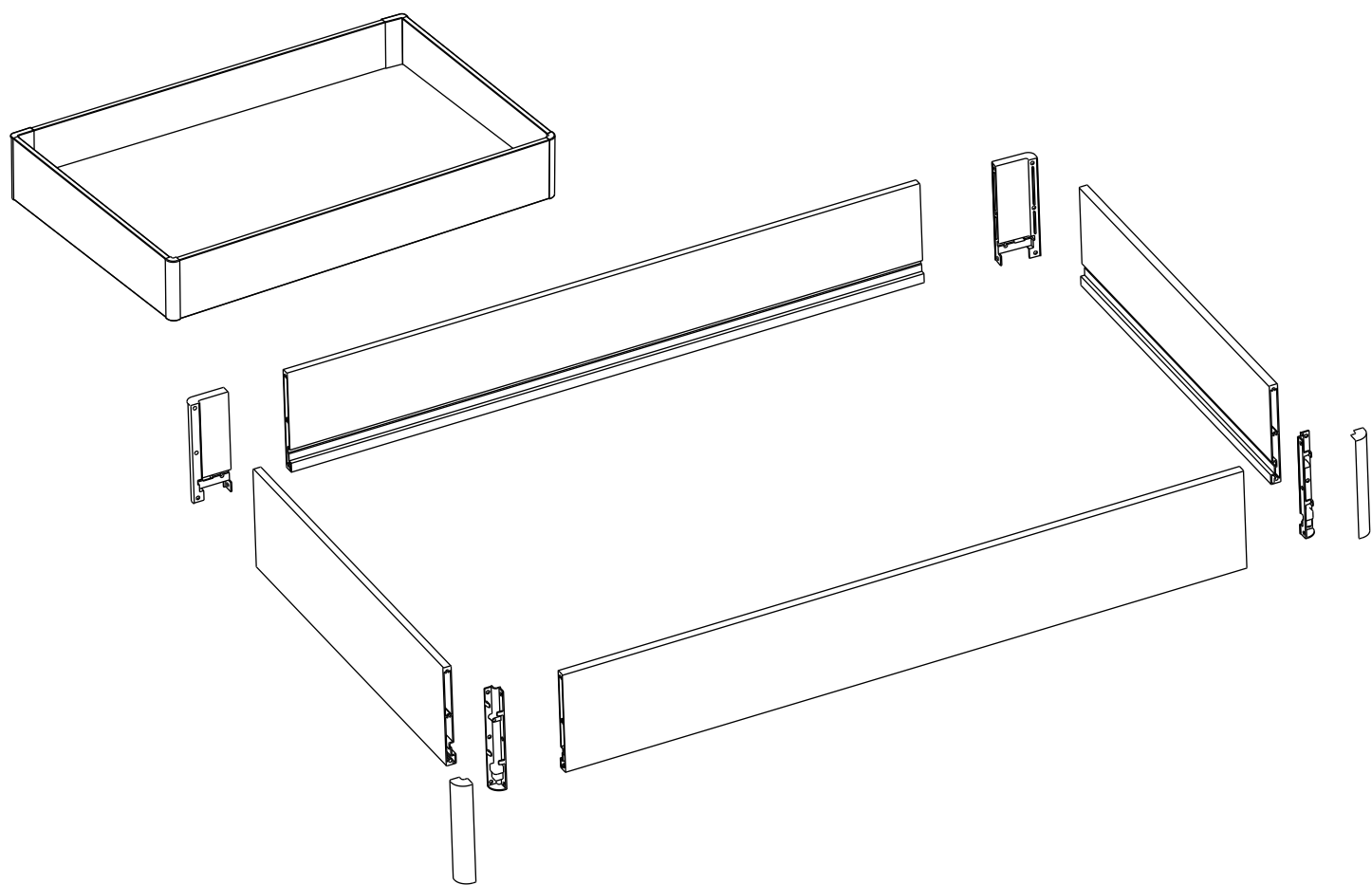

Aluminum frame profile

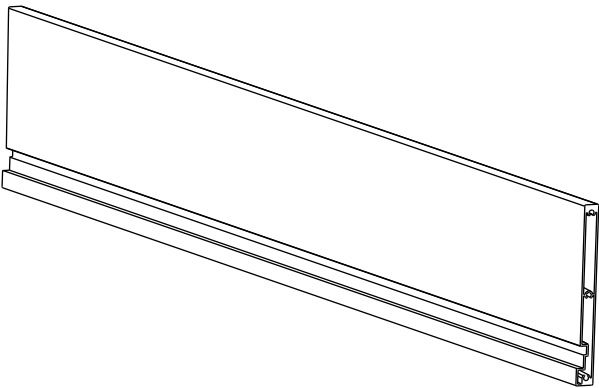

Assembly kit

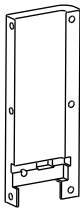

Back angle brackets



Front angle brackets



Cover



Shock absorbers



Screws

**Not supplied:**

Bottom panel 6 or 16 mm thickness  
Guide

# Select Mira Drawer

## Custom Cutting Instructions

### Wardrobe

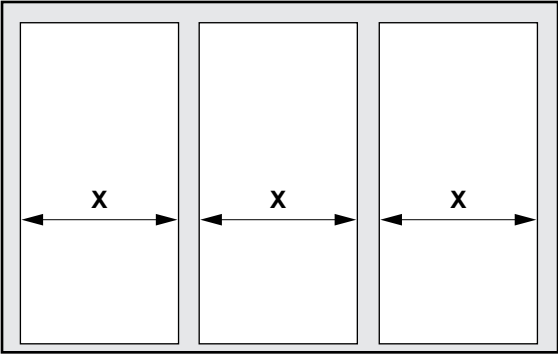

### PROFILE LIST

FRAME PROFILE

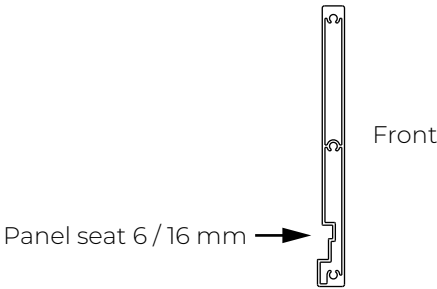

### LEGEND

- X** = wardrobe opening width
- L1** = drawer width
- L2** = drawer depth
- D** = spacer cutting size
- A** = front width cutting size
- B** = back width cutting size
- C** = depth cutting size

### PROFILE CUTTING INDICATIONS

The overall dimensions (L1, L2) are calculated based on the aluminum profiles and not from the zamak details

### DRAWER WITHOUT SPACERS

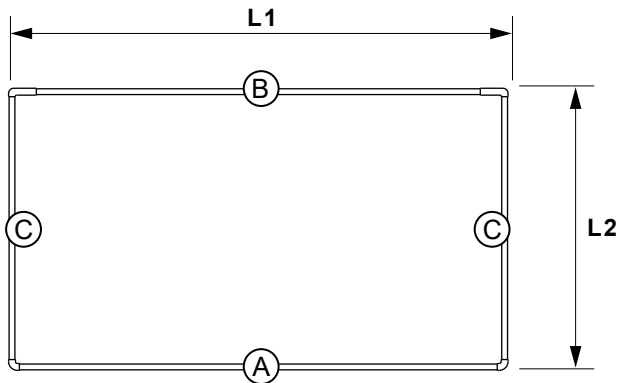

GUIDE BLUM / GRASS

**L1** = X - 16mm

GUIDE HETTICH

**L1** = X - 14mm

- L2** = L. guide + 9 mm (-0+1)  
Example: guide L 450 → L2 = 459mm
- A** = L1 - 36mm (+0-0.5)
- B** = L1 - 99mm (±0.5)
- C** = L2 - 31.5mm (±0.5)

### DRAWER WITH SPACERS

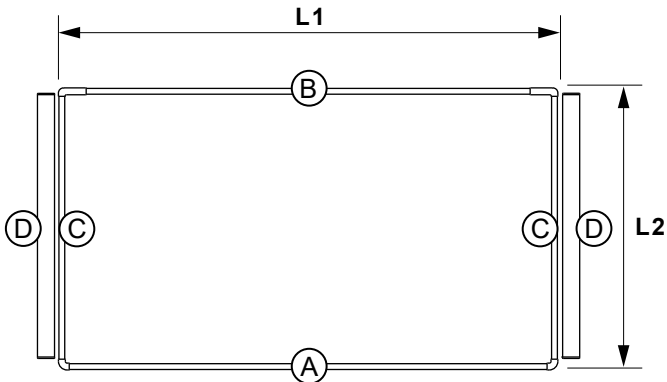

GUIDE BLUM / GRASS

**L1** = X - 59mm

GUIDE HETTICH

**L1** = X - 57mm

- L2** = L. guide + 9 mm (-0+1)  
Example: guide L 450 → L2 = 459mm
- A** = L1 - 36mm (+0-0.5)
- B** = L1 - 99mm (-0+0.2)
- C** = L2 - 31.5mm (±0.5)
- D** = L2 - 35.5mm (-0+0.5)

### BOTTOM PANEL CUTTING INDICATIONS

- SP / THK = 16 mm  
L1 - 17 mm (+0-1) / L2 - 17 mm (+0-1)
- SP / THK = 6 mm  
L1 - 13 mm (+0-1) / L2 - 15 mm (+0-1)

### RECOMMENDED GUIDES

- Blum Tandem 560H (30kg);
- Hettich Quadro V6 EB 20 (30kg); Grass
- Dynapro soft-close EB 21 (40kg)

# Select Mira Drawer Assembly Instructions

1 Screw the back angle brackets with the profile and the sides

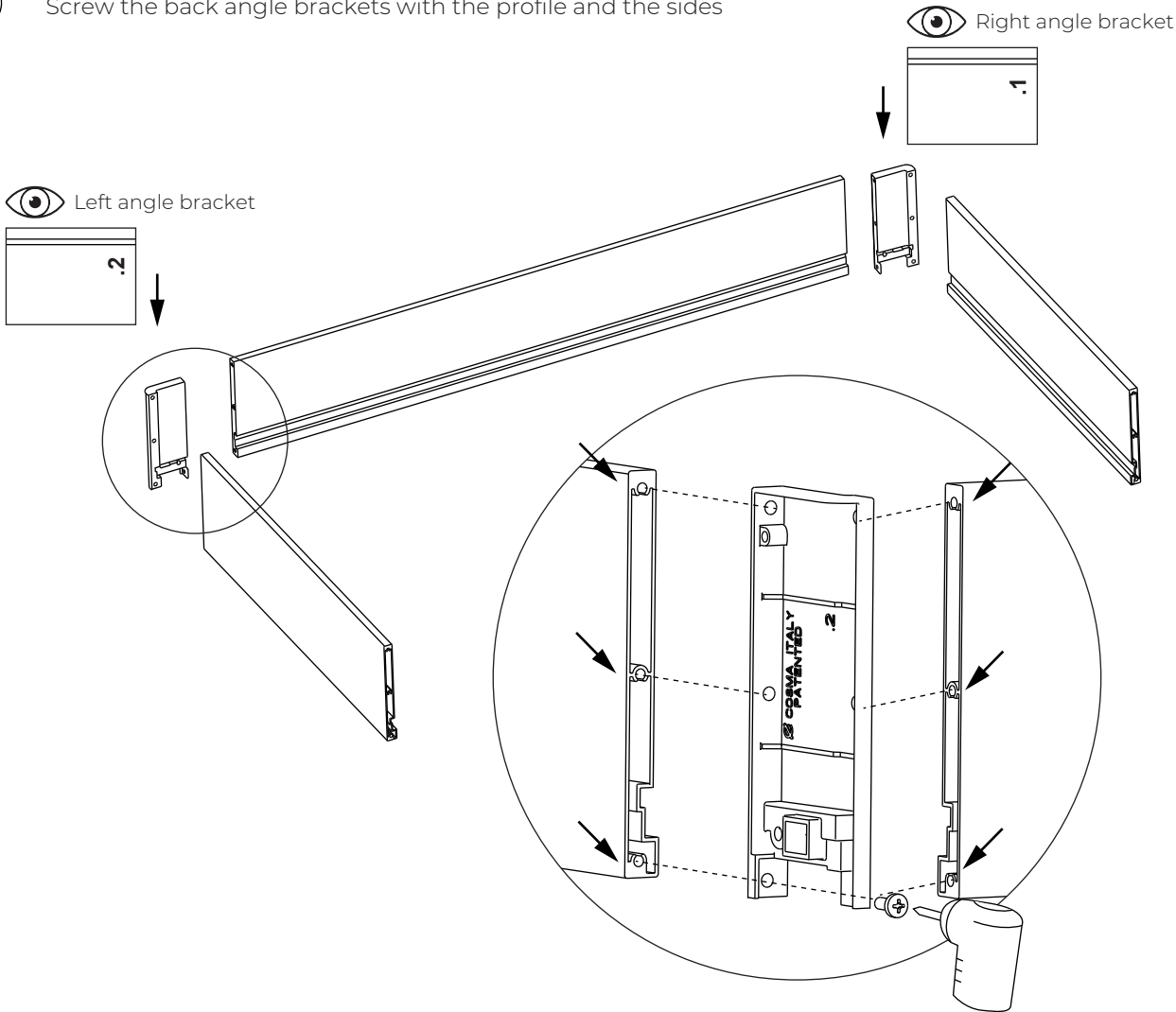

2

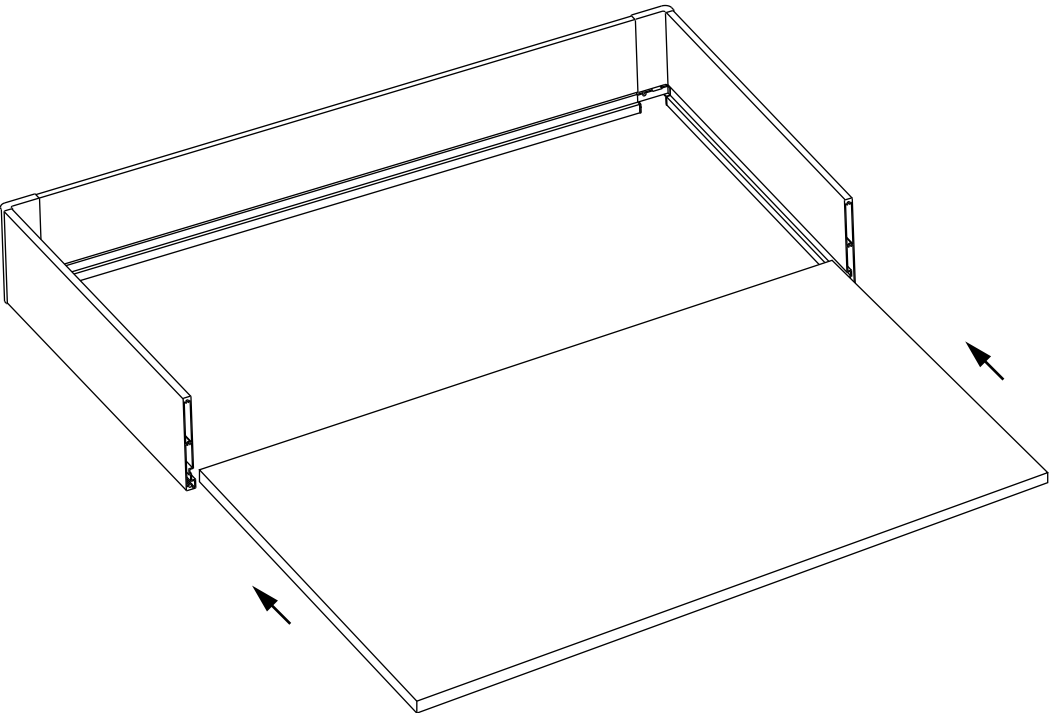

3

Screw the front angle brackets with the profile and the sides

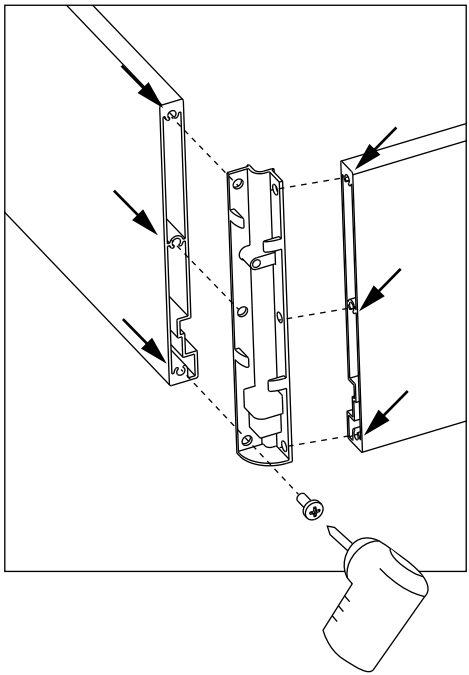
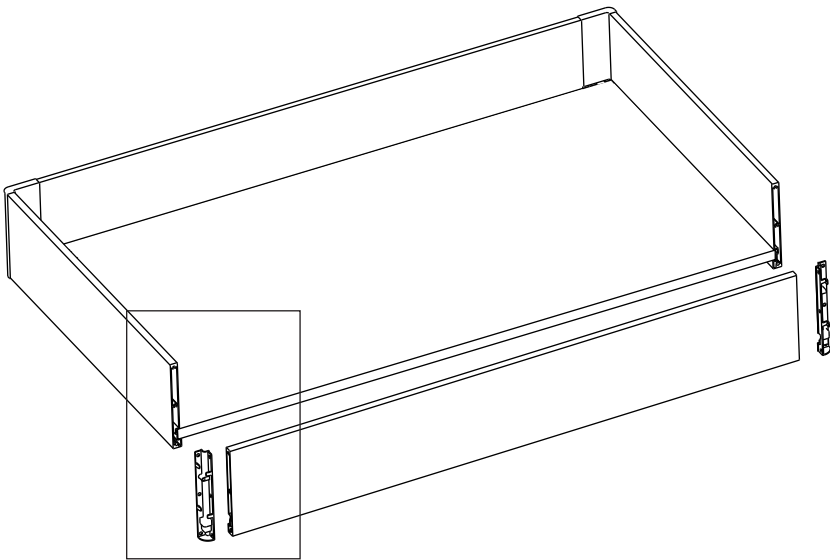

4

Complete the assembly with the covers.

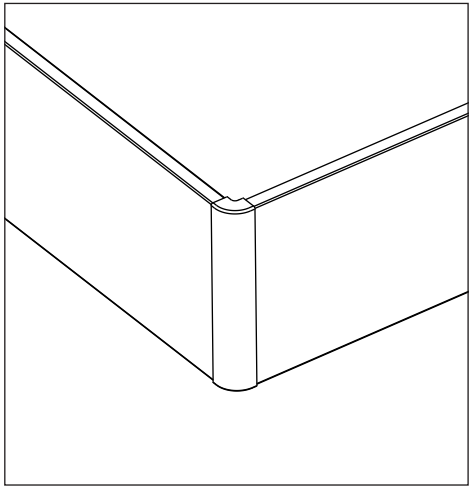
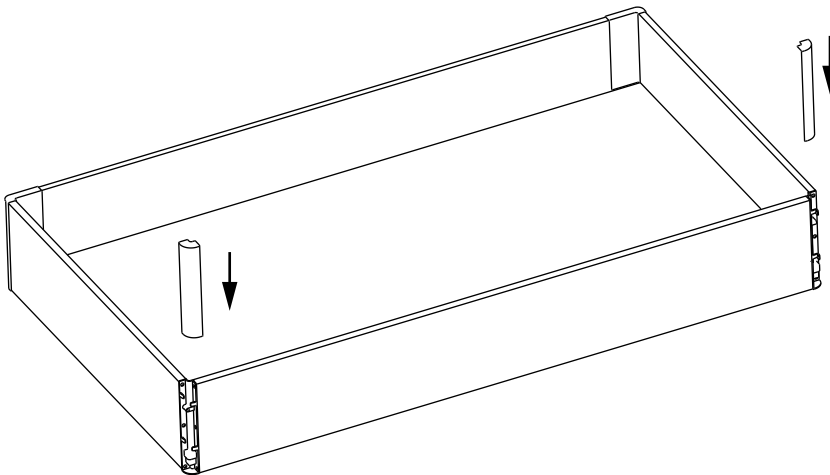

5

Insert the shock absorber for the chosen guide (G = Grass; H = Blum and Hettich)

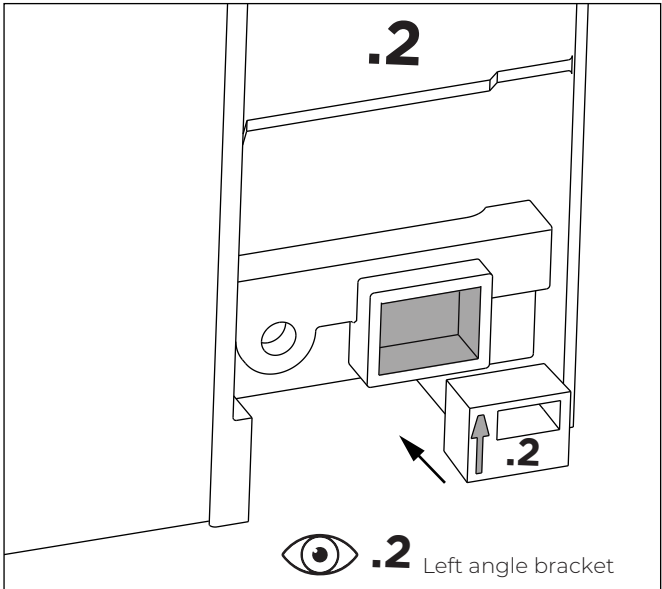
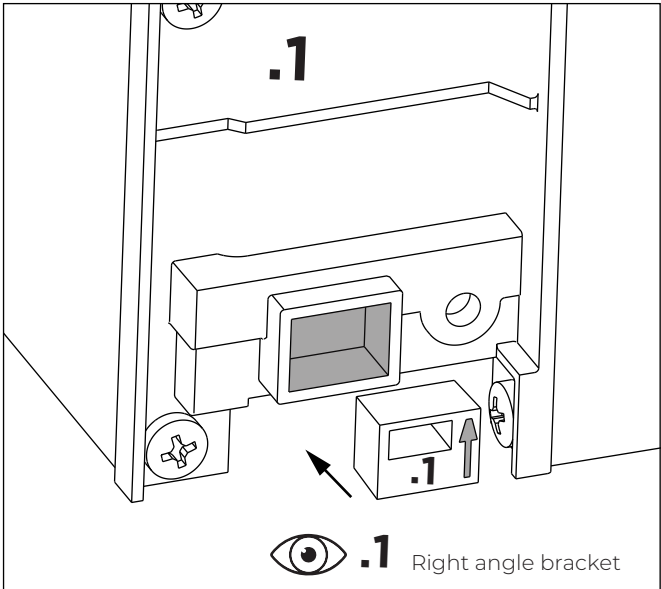

6

Secure the locking device. Use the zamak angle as a reference.

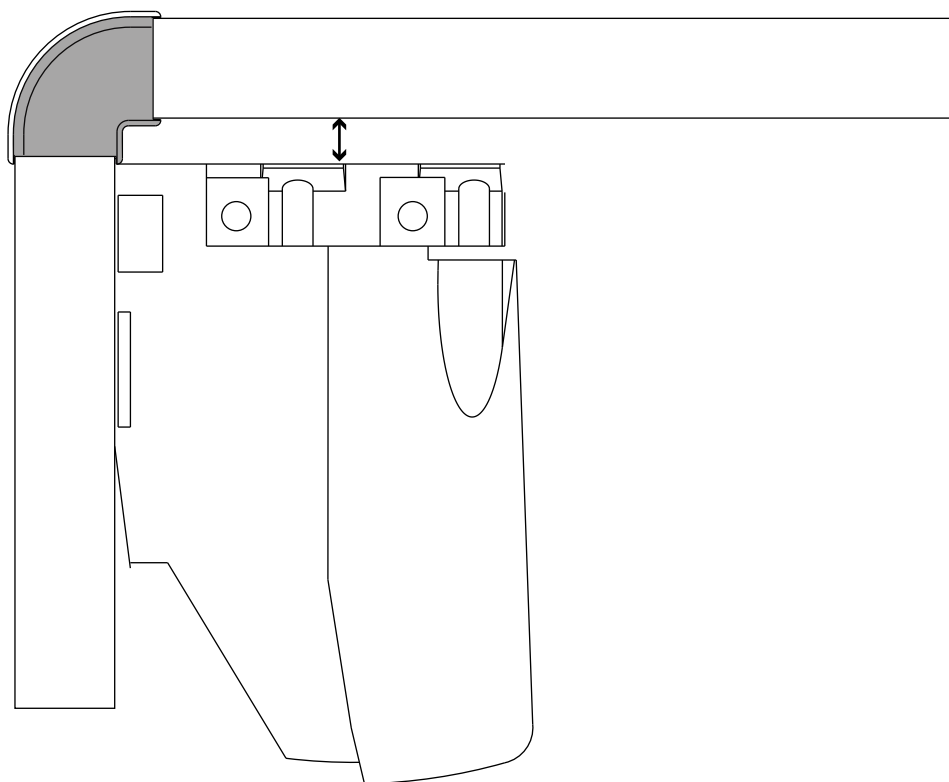

6

Only for spacers and standard spacers assembly



Screws recommended:  
self-tapping screw TPS  $\varnothing 4$  x min. 34

