

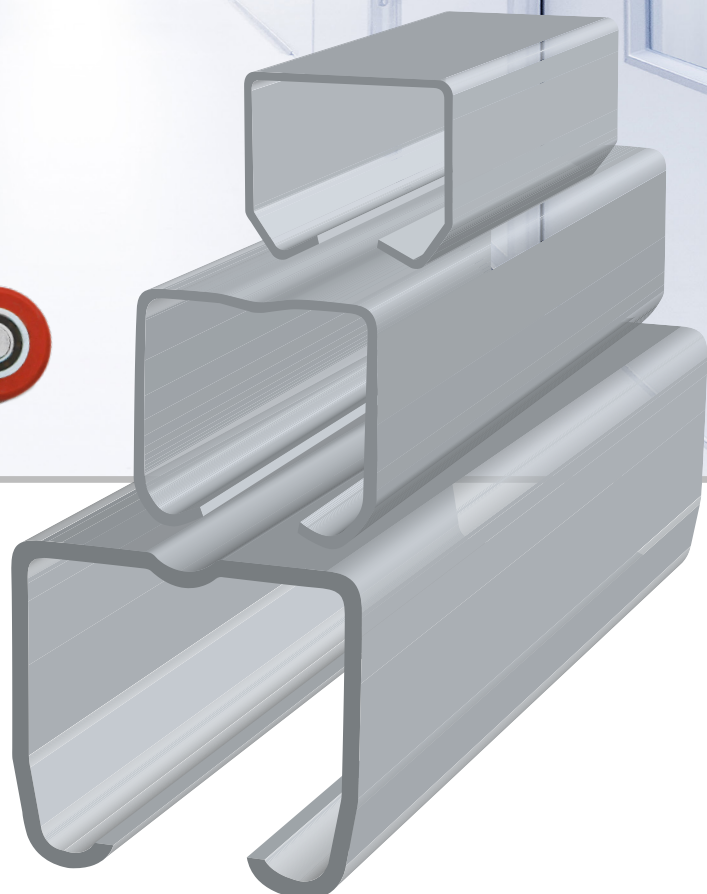

# Industrial Stainless Series

Stainless steel sliding hardware

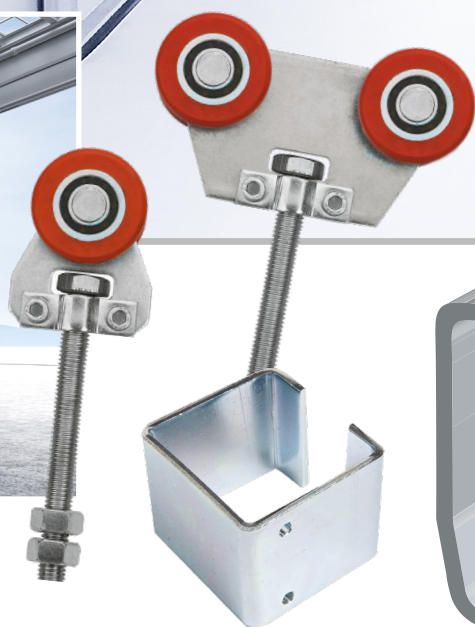

# Overview...

Alongside our proven ranges of industrial and architectural systems **Runners** has developed a range of Stainless Steel systems built from high grade 316 stainless steel ideal for hygiene areas, harsh weather conditions and salt water environments.

These systems include a comprehensive range of tracks, channels and components which are straightforward to install, built to last and offer great value for money.

We recognise that customer service is of utmost importance in today's busy commercial market. To this end **Runners** has an ongoing programme of continual improvement based on customer feedback. We carry large stocks to enable us to rapidly respond to customer needs.

For special requirements and advice, our in-house design team is available to help. Whatever your application, there's a **Runners** system that provides the solution.

**Runners** Industrial is the choice where durability, strength and versatility really matter.

## Typical Applications:

Coastal locations	Overhead runways	Hospitals
Marine buildings	Abattoirs	Industrial doors
Factory dividers	Food processing areas	

## Engineered to last a lifetime

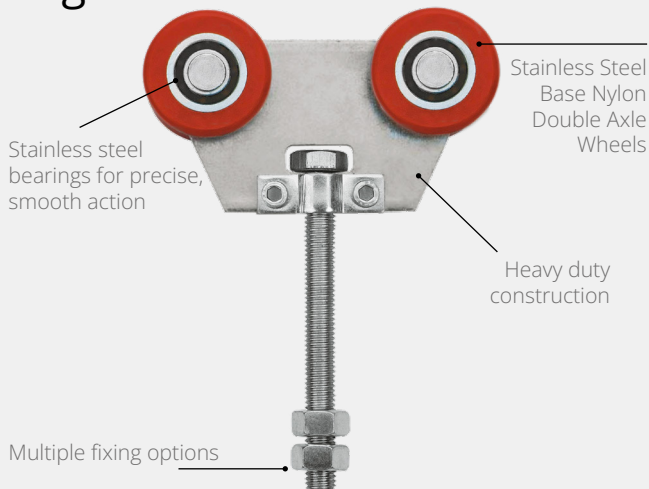

### TECHNICAL SUPPORT

Our team of experts are only a phone call away and can offer technical help and advice on system selection, installation and maintenance.

### SPARES

Runners carry a full range of spares for all our sliding systems. All parts are available for immediate dispatch or collection from our trade counter.







# Introduction

## Stainless Steel Sliding Hardware

Our comprehensive range of stainless track and fittings is ideally suited to applications exposed to harsh weather conditions, including marine, agriculture and the food processing industry.

All components are manufactured from high quality **316 grade stainless steel** suitable for salt water conditions.

### series **75** maximum capacity **75kg per panel**

Stainless steel sliding hardware for door panels up to 75kg.

This product is ideal for lightweight doors or overhead runway applications.

A4/316 grade Stainless steel.

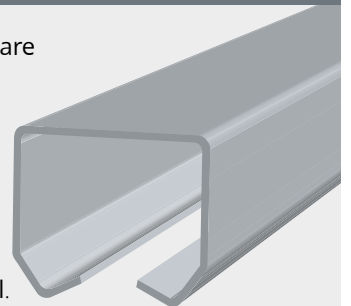

### series **300** maximum capacity **300kg per panel**

Stainless steel sliding hardware for door panels up to 300kg.

The series 300 is frequently used for large external doors on commercial and agricultural buildings.

A4/316 grade Stainless steel.

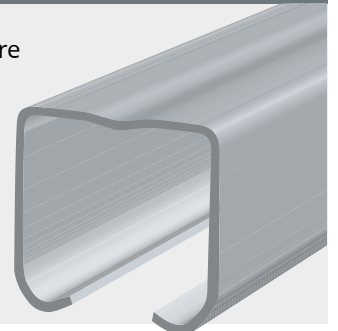

### series **450** maximum capacity **450kg per panel**

Stainless steel sliding hardware for doors up to 450kg.

Our heavy duty range the series 450 is the answer to those heavy weight applications.

A2/304 or A4/316 grade Stainless steel.

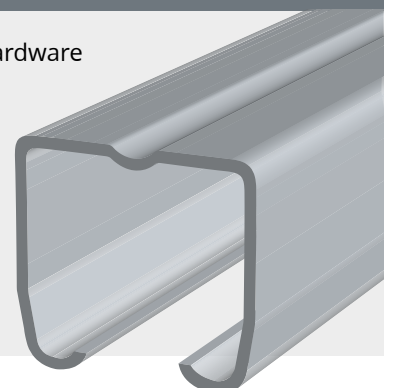



**runners**  
SLIDING SYSTEMS

series **75**

## Stainless steel hardware sliding doors upto 75kg

Our comprehensive range of stainless track and fittings is ideally suited to applications exposed to harsh weather conditions, including marine, agriculture and the food processing industry.

All components, track and channel are manufactured from A4/316 grade Stainless steel.

## Tracks & Guides

### Stainless Steel Series 75

**75-4760**

Stainless steel  
top track.

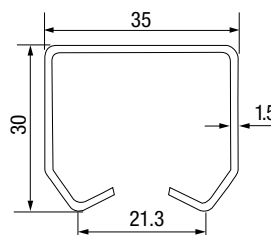

Length	Part No.
3 metre	<b>75-4760-3</b>

- The Stainless Steel Top Track is manufactured with drilled holes.
- Two hangers must be used for stability and maximum weight capacity.

### Stainless Steel Series 75 Curved upper track

**75-47351**

Stainless steel  
top track.

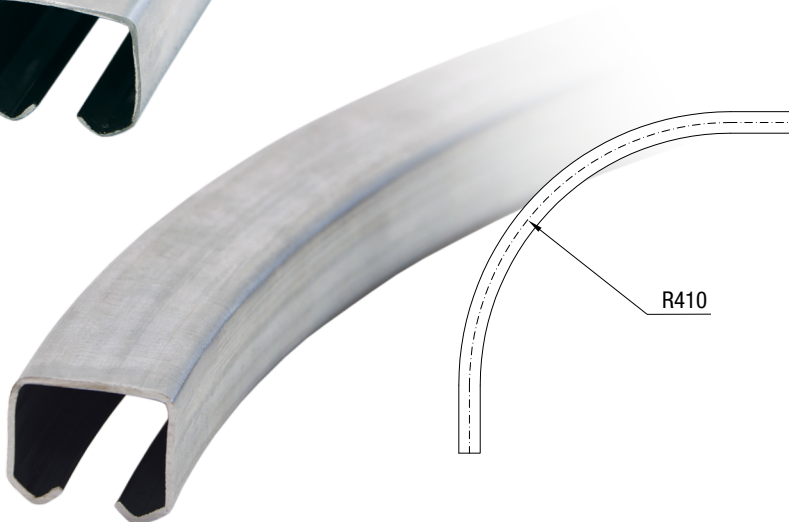

Length	Part No.
3 metre	<b>75-47351-3</b>

- The Stainless Steel Top Track is manufactured with drilled holes.
- Two hangers must be used for stability and maximum weight capacity.

### Stainless Steel Top Track Joint

**75-47311**

Component used for  
joining two tracks

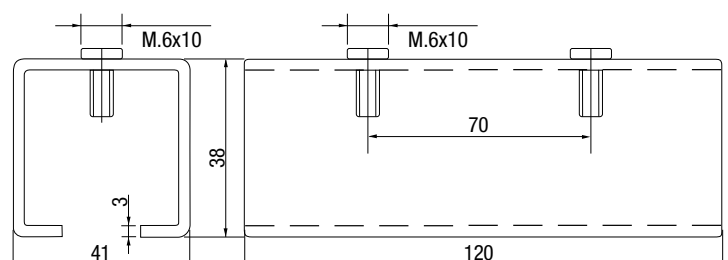

**runners**  
SLIDING SYSTEMS

Contact for further information

01280 822288 | [www.runners-uk.co.uk](http://www.runners-uk.co.uk) | [sales@runners-sales.com](mailto:sales@runners-sales.com)



# Tracks & Guides

## Stainless Steel Double Wheel Hanger

**75-4641**

This double wheel hanger has 4 nylon wheels. The central bolt can be removed for easy maintenance or repair.

Weight capacity is 75kg per pair.

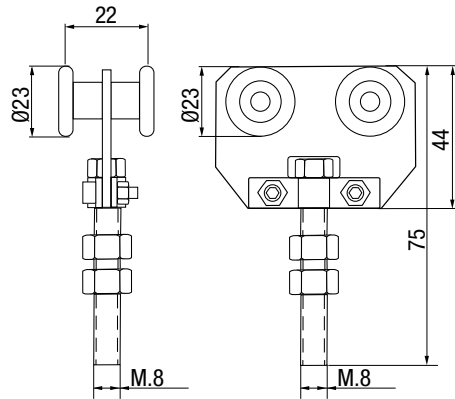

## Stainless Steel Track Stop

**75-47312**

Stainless steel track stop which can be locked at any position along the track. The rollers buffer against the rubber stop.

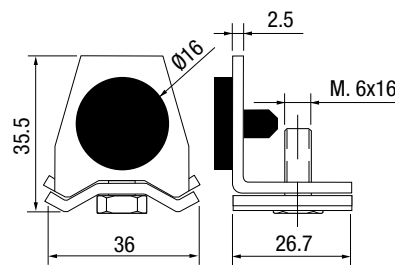

## Stainless Steel Bottom Guide Channel

**300-486-3**

For a better operation of the door, it is recommended the use of the bottom guides.



## Stainless Steel Curved Bottom Guide Channel

**75-48120**

For a better operation of the door, it is recommended the use of the bottom guides.

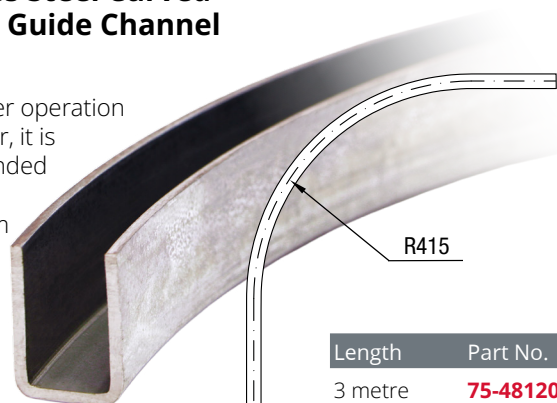

## Lower Nylon Guide

**75-5006**

Ideal for wooden doors simply machine a groove in the bottom of the door.

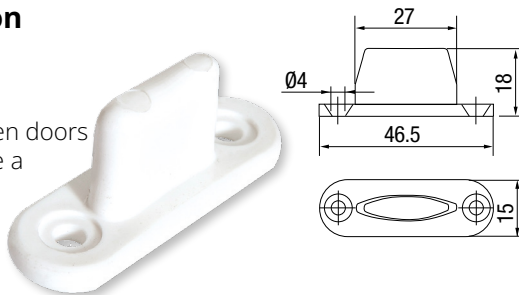

## Stainless Steel Bottom Guide Roller

**300-791**

Stainless steel bottom guide roller with M16 threaded pin. To be used with 100-486 guide channel.

For a better operation of the door, it is recommended the use of the bottom guides.

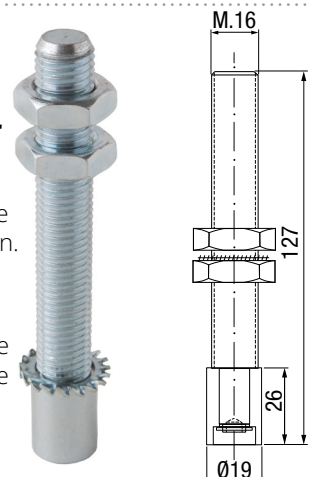





# series **75**

## Stainless steel hardware sliding doors upto 75kg

Our comprehensive range of stainless track and fittings is ideally suited to applications exposed to harsh weather conditions, including marine, agriculture and the food processing industry. All components, track and channel are manufactured from A4/316 grade Stainless steel.

# series 300

Stainless steel hardware  
for sliding doors up to 300kg

Our comprehensive range of stainless track and fittings is ideally suited to applications exposed to harsh weather conditions, including marine, agriculture and the food processing industry. All components, track and channel are manufactured from A4/316 grade Stainless steel.

## Tracks & Guides

### Stainless Steel Top Track

**300-472-3**

The stainless steel top track for sliding doors allows for the sliding door movement.

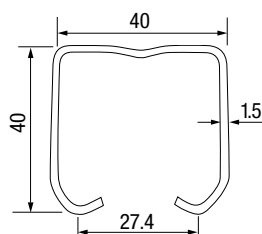
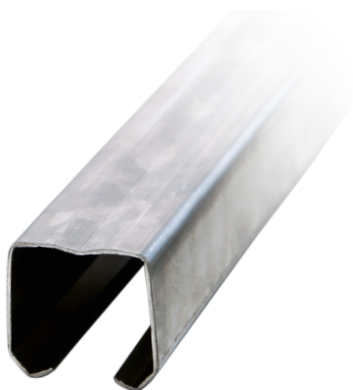

Length	Part No.
3 metre	<b>300-472-3</b>

■ Two hangers have to be used for stability and maximum weight capacity.

### Stainless Steel Curved Top Track

**300-4771-3**

The stainless steel top track for sliding doors allows for the sliding door movement.

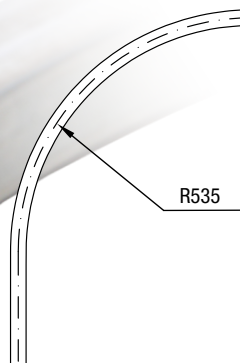
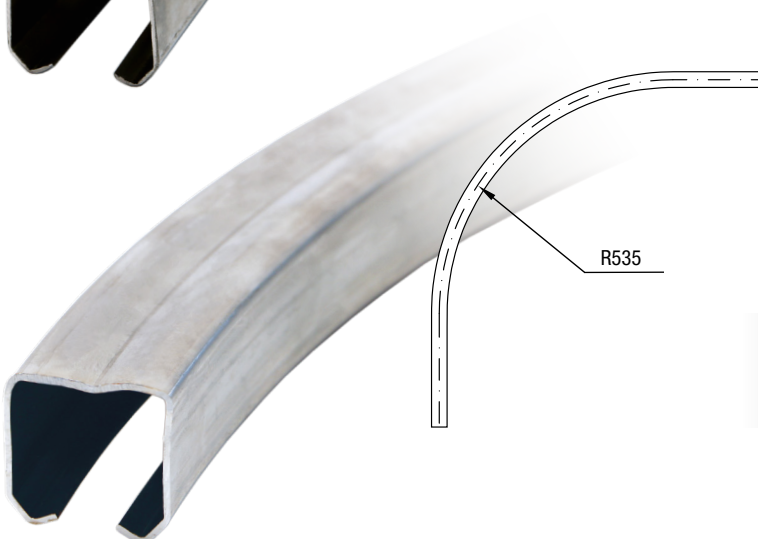

Length	Part No.
3 metre	<b>300-4771-3</b>

■ Two hangers have to be used for stability and maximum weight capacity.

### Stainless Steel Top Track Joint

**300-47811**

Component used for joining two tracks

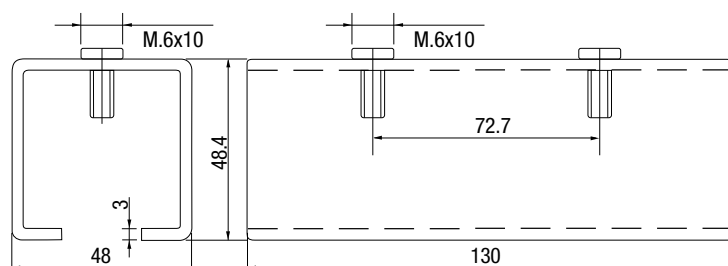



# Tracks & Guides

## Stainless Steel Adjustable Top Track Bracket

**300-47860**

Soffit bracket with height adjustable thread.  
We recommend to install rail supports every 500mm.

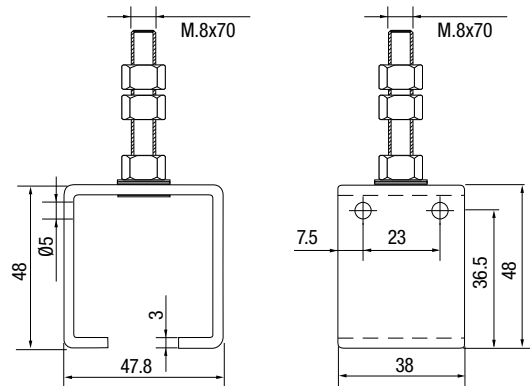
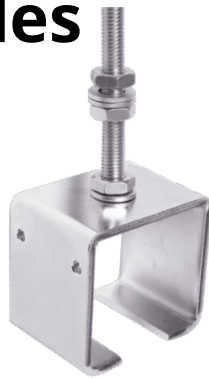

## Stainless Steel Top Track Bracket for face fixing

**300-47850**

Face fix wall mounted bracket. We recommend to install rail supports every 500mm.

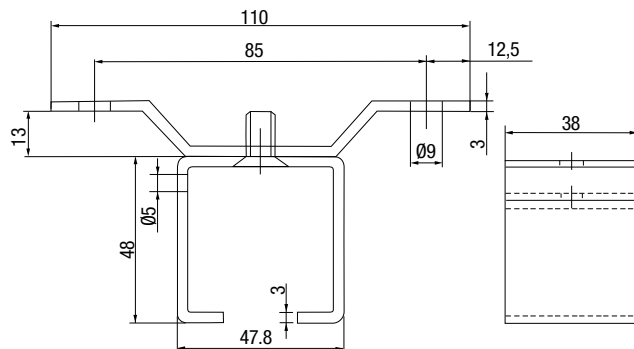

## Stainless Steel Top Track Bracket for Ceiling Attachment

**300-47870**

Soffit fix bracket.  
We recommend to install rail supports every 500mm.

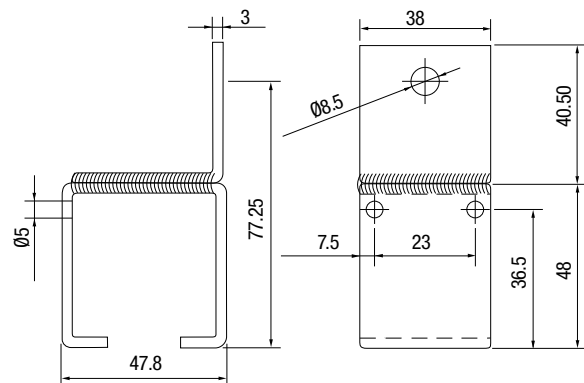

## Stainless Steel Top Track Bracket for Welding

**300-47830**

This bracket is designed to be welded in position.  
We recommend to install rail supports every 500mm.

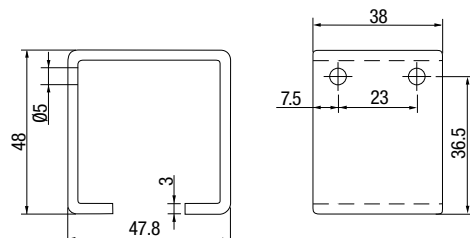

## Stainless Steel Track Stop

**300-47812**

Stainless steel track stop can be fixed at any position along the track.  
Rubber buffer cushions impact from the hanger.

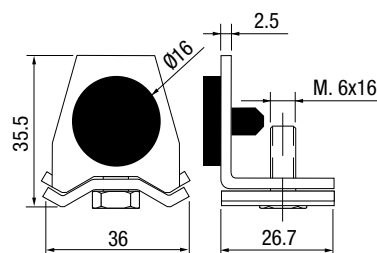

# Tracks & Guides

## Stainless Steel Single Axle Wheel Hanger

**300-468**

Weight capacity is 150kg per pair.

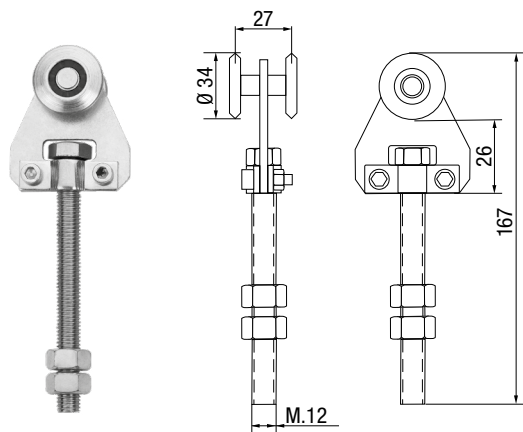

## Stainless Steel Double Axle Wheel Hanger Series 300

**300-469**

Weight capacity is 300kg per pair.

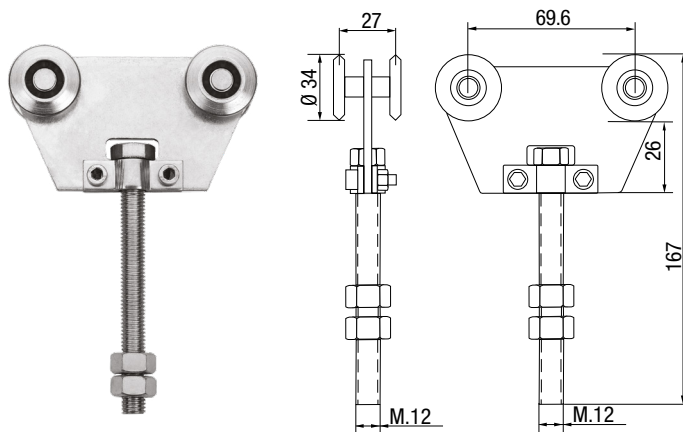

## Stainless Steel Bottom Guide Channel

**100-486-3**

For a better operation of the door, it is recommended the use of the bottom guides.

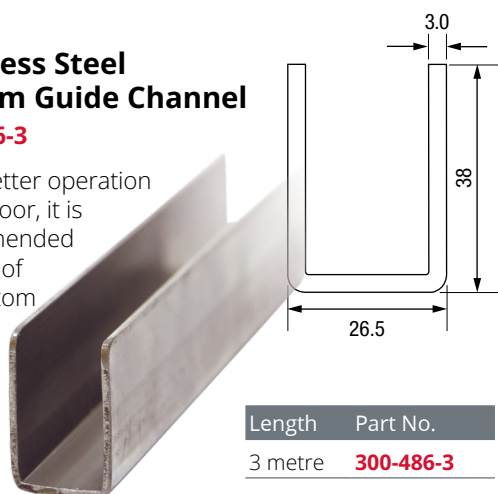

## Stainless Steel Curved Bottom Guide Channel

**300-4810-3**

For a better operation of the door, it is recommended the use of the bottom guides.

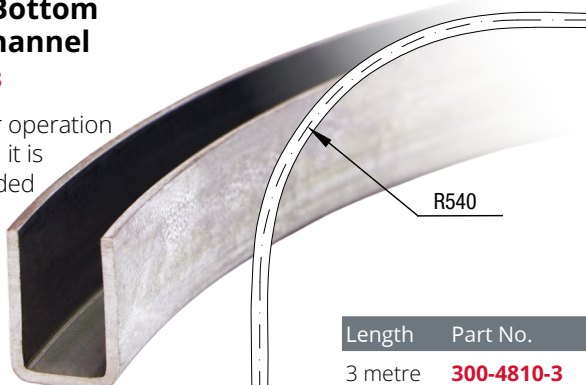

## Stainless Steel Bottom Guide Roller

**300-791**

Stainless steel bottom guide roller with M16 threaded pin. To be used with 100-486 guide channel.

For a better operation of the door, it is recommended the use of the bottom guides.

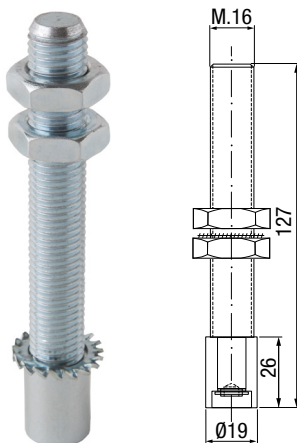

### ■ TECHNICAL SUPPORT

Our team of experts are only a phone call away and can offer technical help and advice on system selection, installation and maintenance.

### ■ SPARES

Runners carry a full range of spares for all our sliding systems. All parts are available for immediate dispatch or collection from our trade counter.



stainless series **300**

# series **300**

Stainless steel hardware  
for sliding doors up to 300kg

Our comprehensive range of stainless track and fittings is ideally suited to applications exposed to harsh weather conditions, including marine, agriculture and the food processing industry. All components, track and channel are manufactured from A4/316 grade Stainless steel.







**runners**  
SLIDING SYSTEMS

series **450**

Stainless steel hardware  
for sliding doors up to 450kg

Our comprehensive range of stainless track and fittings is ideally suited to applications exposed to harsh weather conditions, including marine, agriculture and the food processing industry. All components are manufactured from A2/304 grade Stainless steel. Tracks are manufactured from A2/304 and A4/316 grade Stainless steel.

## Tracks & Guides

### Stainless Steel Top Track

**450-485**  
**450-48516**

Two hangers  
have to be used  
for stability and  
maximum weight  
capacity.

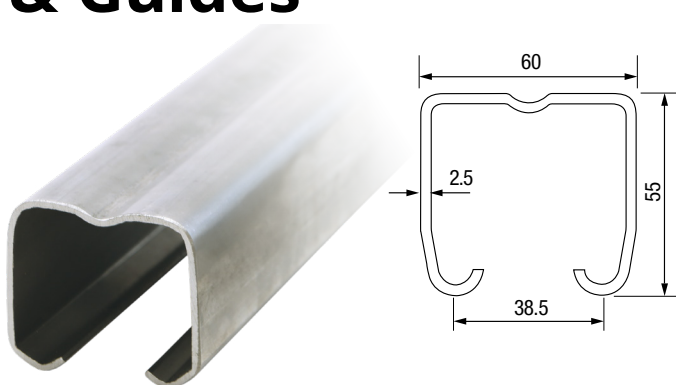

Length	Part No.	Grade
3 metre	<b>450-485</b>	<b>A2/304</b>
3 metre	<b>450-48516</b>	<b>A4/316</b>

- The Stainless Steel Top Track is manufactured with drilled holes.
- Two hangers must be used for stability and maximum weight capacity.

### Stainless Steel Curved Top Track

**450-4804**  
**450-4806**

Stainless steel  
top track.

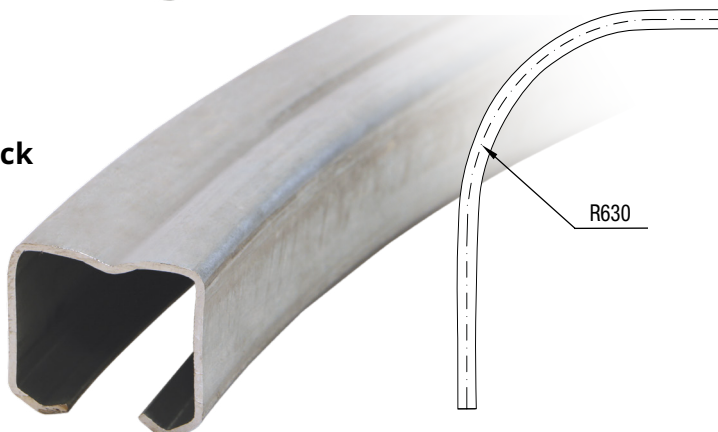

Length	Part No.	Grade
3 metre	<b>450-4804</b>	<b>A2/304</b>
3 metre	<b>450-4806</b>	<b>A4/316</b>

- Stainless Steel Series 450 Top Tracks are manufactured in stainless steel. A2/304 is our standard stainless steel grade.
- For Marine or coastal applications, please use A4/316 grade.

### Stainless Steel Top Track Joint

**450-47911**

Component used for  
joining two tracks.

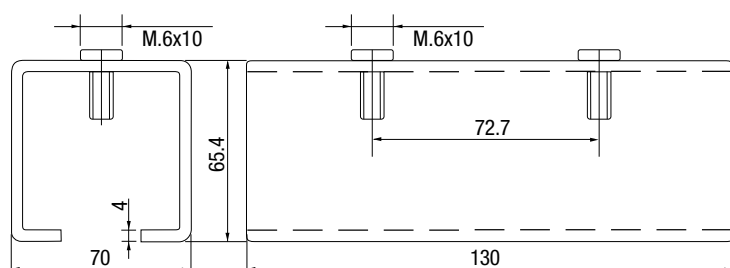
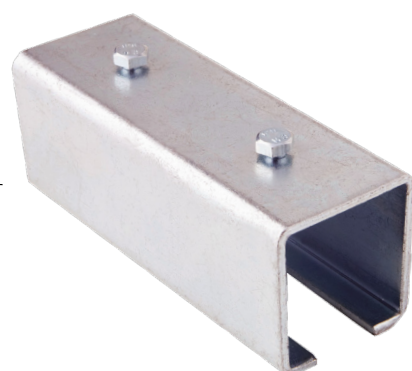



# Tracks & Guides

## Stainless Steel Top Track Bracket for Welding

**450-47930**

This bracket is designed to be welded in position.

We recommend to install rail supports every 500mm.

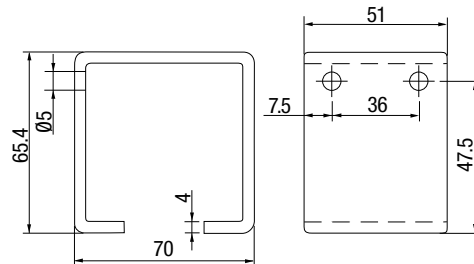

## Stainless Steel Top Track Bracket for face fixing

**450-47950**

Face fix wall mounted bracket.

We recommend to install rail supports every 500mm.

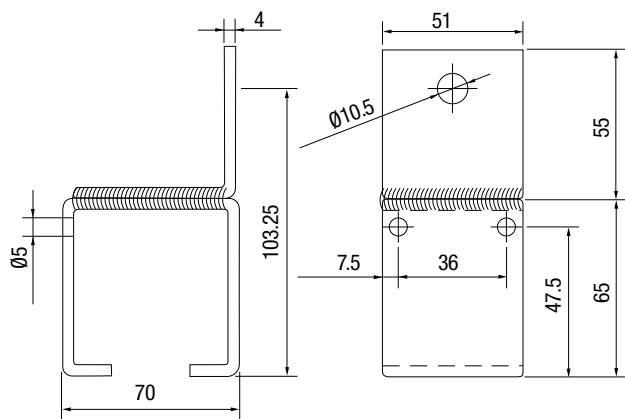

## Stainless Steel Adjustable Top Track Bracket

**450-47960**

Soffit fix bracket with height adjustable thread.

We recommend to install rail supports every 500mm.

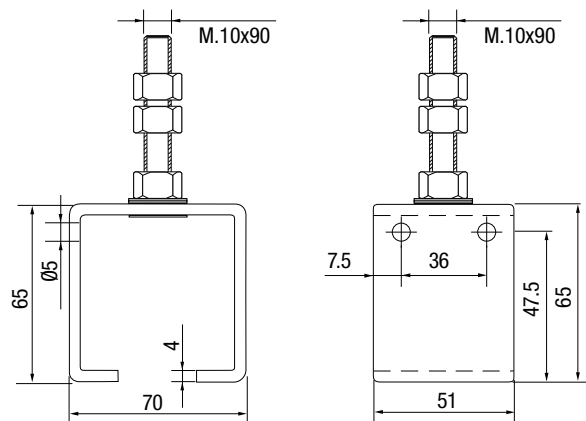

## Stainless Steel Bottom Guide Roller

**300-791**

Stainless steel bottom guide roller with M16 threaded pin. To be used with 100-486 guide channel.

For a better operation of the door, it is recommended the use of the bottom guides.

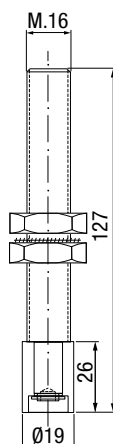

### ■ TECHNICAL SUPPORT

Our team of experts are only a phone call away and can offer technical help and advice on system selection, installation and maintenance.

### ■ SPARES

Runners carry a full range of spares for all our sliding systems. All parts are available for immediate dispatch or collection from our trade counter.

# Tracks & Guides

## Stainless Steel Nylon Single Axle Wheel Hanger

**450-483**

Weight capacity is  
240kg per pair.

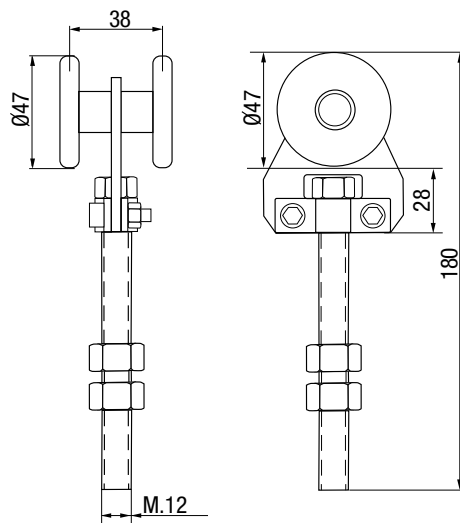

## Stainless Steel Nylon Double Axle Wheel Hanger

**450-484**

Weight capacity is  
450kg per pair.

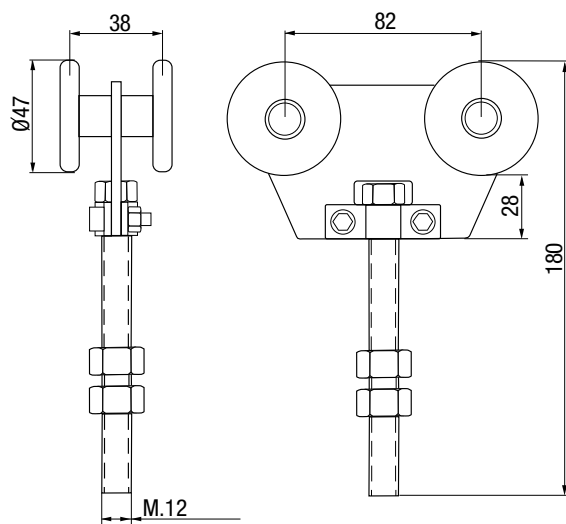
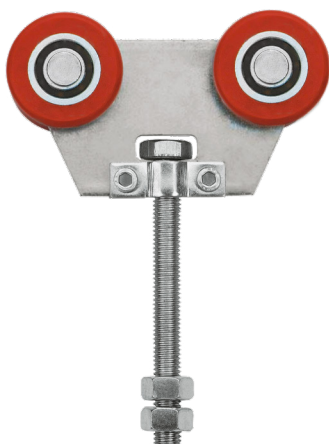

## Stainless Steel Bottom Guide Channel

**300-486-3**

For a better operation  
of the door, it is  
recommended the  
use of the  
bottom  
guides.

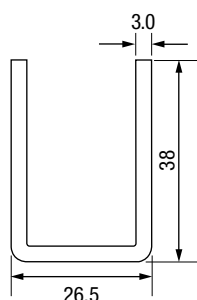

Length	Part No.
3 metre	<b>300-486-3</b>

## Stainless Steel Curved Bottom Guide Channel

**450-48110**

For a better operation  
of the door, it is  
recommended  
the use of  
the bottom  
guides.



Length	Part No.
3 metre	<b>450-48110-3</b>



stainless series **450**

# series **450**

## Stainless steel hardware for sliding doors up to 450kg

Our comprehensive range of stainless track and fittings is ideally suited to applications exposed to harsh weather conditions, including marine, agriculture and the food processing industry. All components are manufactured from A2/304 grade Stainless steel. Tracks are manufactured from A2/304 and A4/316 grade Stainless steel.





# Keeping your trailers in action – sliding solutions for curtain siders.



**runners**  
SLIDING SYSTEMS



Runners Sliding Systems  
Signal Hill  
Lenborough Road  
Gawcott  
Buckingham  
MK18 4BU

Tel: 00 44 (0)1280 822288  
Fax: 00 44 (0)1280 813024  
Email: [sales@runners-sales.com](mailto:sales@runners-sales.com)  
Web: [www.runners-uk.com](http://www.runners-uk.com)

Other products available from Runners Sliding Systems



**tommafold**® Architectural Folding Door Systems  
for Timber Doors



**multirail**  
& SMART SPRAY  
Overhead Runway Systems



**trakkit**  
Sliding Door Kits