

tommafold[®]interior

Interior Folding Door System - Fitting Instructions

Please read these instructions fully before installation.

- MAX DOOR WEIGHT 60kg
- MAX LEAF WIDTH 900mm
- MAX LEAF HEIGHT 3000mm
- MINIMUM DOOR THICKNESS 35mm

Max panel weight

60kg

Suitable for residential and light commercial pivot folding partitions, with all panels of equal width. Panels can fold to one or both sides of the opening. To cover any width opening, any number of folding units can be used.

A Components

Depending on your chosen door configuration the quantities of each component will vary.

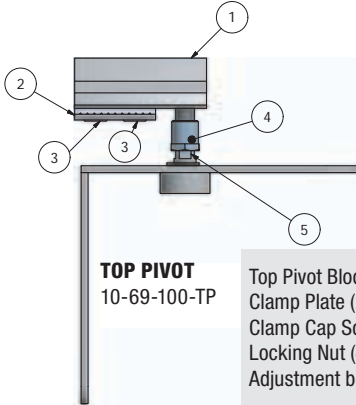

TOP PIVOT
10-69-100-TP

Top Pivot Block (1)
Clamp Plate (2)
Clamp Cap Screws (3)
Locking Nut (4)
Adjustment bolt (5)

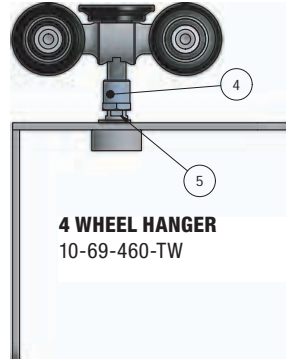

4 WHEEL HANGER
10-69-460-TW

TOP TRACK

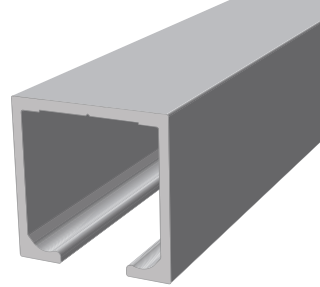

HINGE SET

60-300-SS

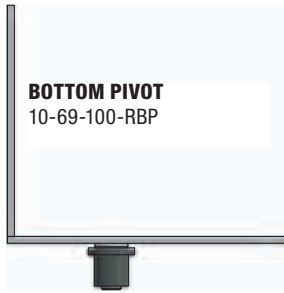
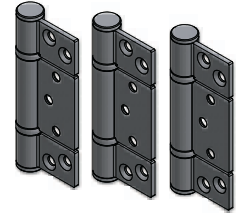

BOTTOM PIVOT
10-69-100-RBP

OPTIONS

BOTTOM GUIDE (optional)

10-69-100-BG

For use when optional bottom track is installed.

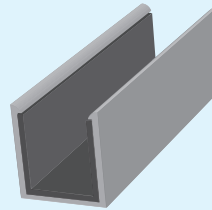

BOTTOM TRACK (optional)

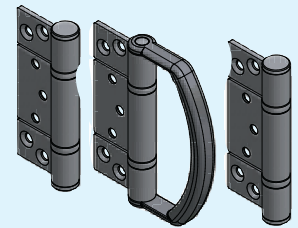

HINGE HANDLE SET (optional)
60-320-SS

B Typical hardware configurations

- A TOP PIVOT
- B BOTTOM PIVOT
- C 4 WHEEL HANGER
- D BOTTOM GUIDE (optional)
- E HINGE SET
- F HINGE HANDLE SET (optional)
- G FLUSH BOLT (optional)

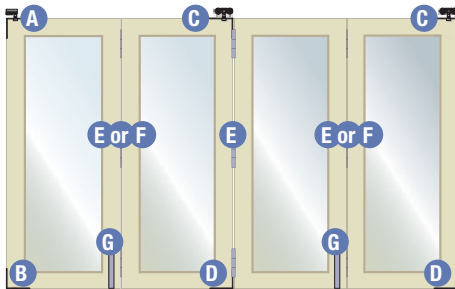
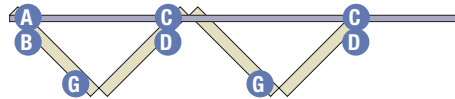

4 doors folding one way

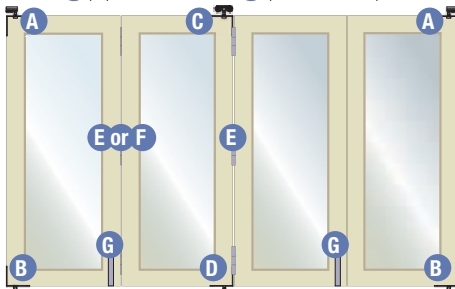
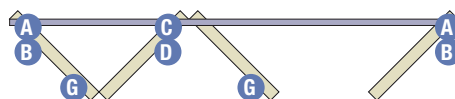

3 doors folding one way with an access door

1 Head preparation

Prepare the head according to the dimensions shown below.

NOTE: Dimensions shown in blue for joinery section sizes are suggestions only.

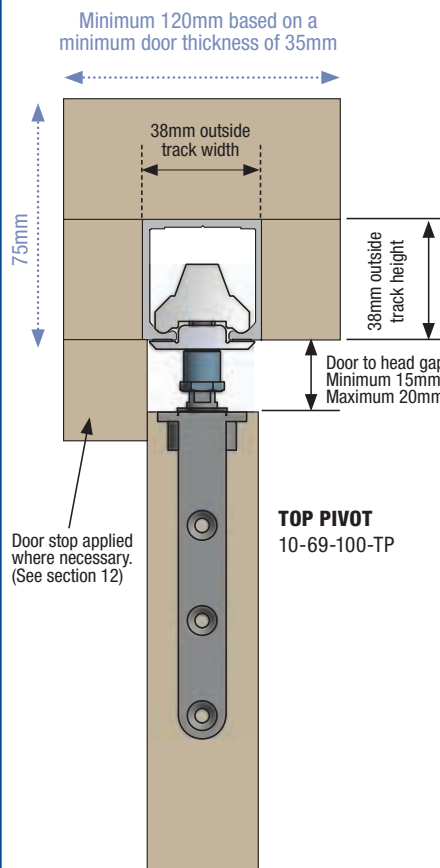

TOP PIVOT
10-69-100-TP

2 Bottom track (optional)

If using a bottom track it should be recessed into the floor and fixed with either adhesive or screws. The following measurements should be observed. The bottom track should be aligned central to the top track.

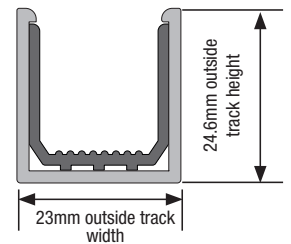

Cut the bottom track to allow a minimum gap of 40mm between the end of the bottom track and the centre line of any bottom pivots. If there is a pivot set at the opposite end then repeat the same procedure there.

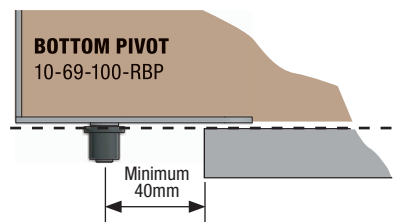

BOTTOM PIVOT
10-69-100-RBP

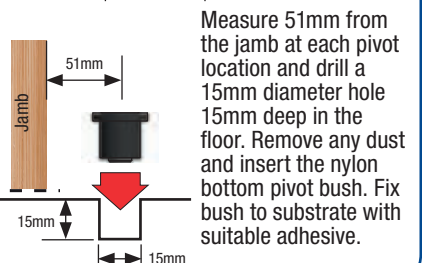

Measure 51mm from the jamb at each pivot location and drill a 15mm diameter hole 15mm deep in the floor. Remove any dust and insert the nylon bottom pivot bush. Fix bush to substrate with suitable adhesive.

3 Calculating door leaf sizes.

1 CONFIGURATION
Decide on a configuration layout.

2 CLEARANCES
With all configurations you need to allow for the following clearances:

- Jamb to door : - 6mm (See jamb detail drawing below).
- Panel to panel: - 4mm
- Bottom of door to sill: - 6mm
- Top of door to head: - 18mm

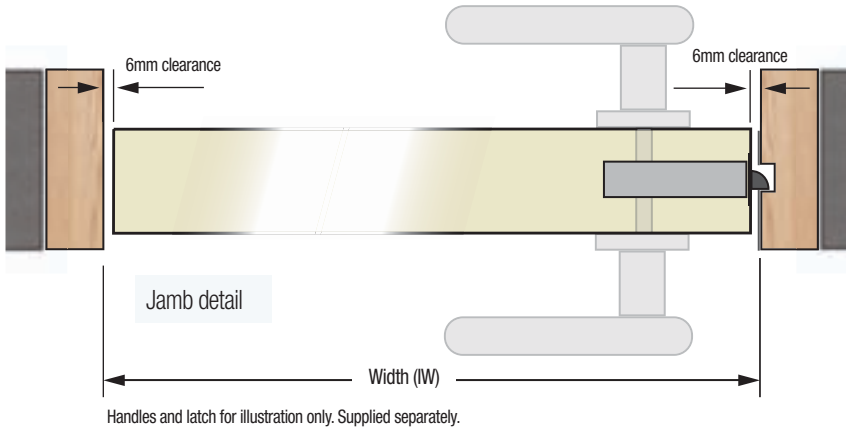

Door Width Calculation formula:
$$IW - 12 - (4 \times (N - 1))$$

Calculation key:
N
IW = Inside frame width (measuring across inside stepped rebate)
N = Number of doors

WORKED EXAMPLE

3 right & 1 left configuration:

Inside frame opening size: **3500mm wide x 2150mm high**

Door widths =
$$\frac{3500 - 12 - (4 \times (4 - 1))}{4} = 4 \text{ panels } 869\text{mm wide}$$

Door heights =
2150 (aperture height) - **18** (door top to head) - **6** (door bottom to sill)
 = door height of 2135mm

4 Fitting the hardware to the doors

Fit all pivot sets and hangers to the appropriate doors. These should be recessed into the doors so they are flush as shown below. See page 1 section B for typical configurations. You should also pre-drill the doors at this stage for the hinge sets (See section 8). **DO NOT RECESS THE HINGES.**

Door bolts

If flush bolts are to be used please see section 11 for technical details. These should also be recessed into the doors at this stage, before mounting the doors on the track. Surface mounted bolts may be fitted at this stage or afterwards.

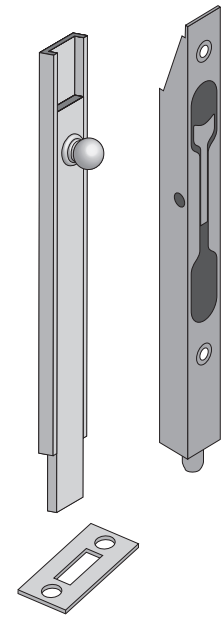
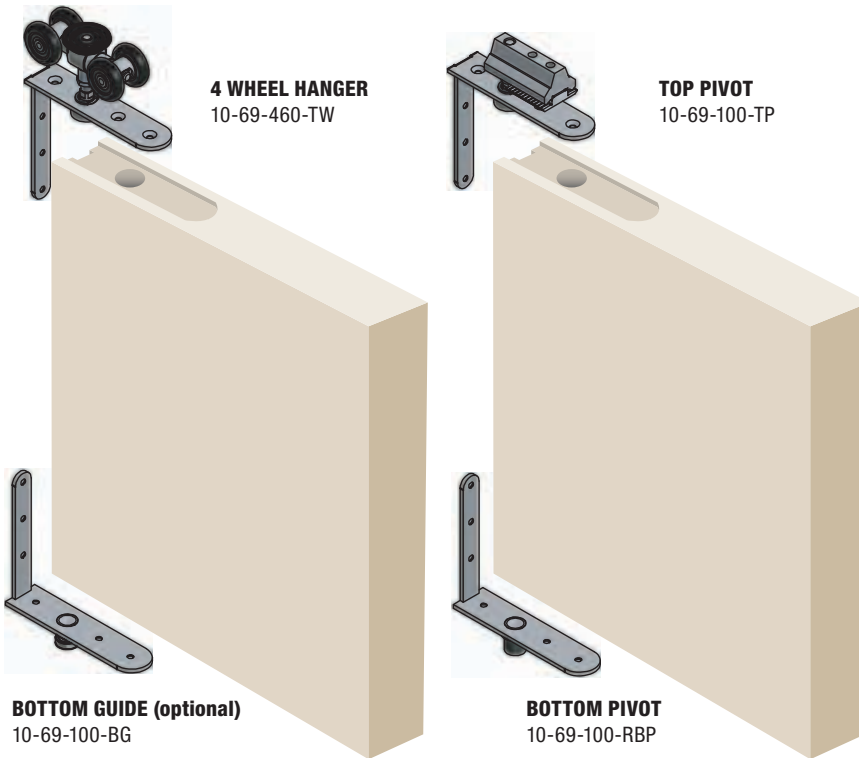

5 Fitting the top track

The top track should be measured to fit the frame width and then a piece 150mm long should be trimmed off one end and retained. The track is supplied pre-drilled at 300mm centres, but will also require additional drilling approximately 20mm from each end and also where the two pieces of track join. Use 5mm (10 gauge) screws to fix the long section of track to the head first. If the hardware set only contains one pivot set then the short section of track should be positioned at the opposite jamb from the pivot side. **DO NOT FIT THE SHORT PIECE AT THIS STAGE. SEE SECTION 7.**

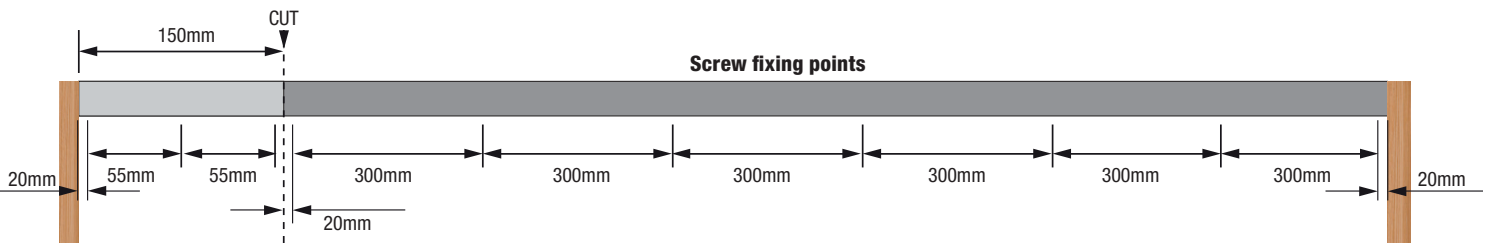

6 Mounting the doors

First loosen the clamp cap screws on the top pivot and unscrew them as far as they will go, but not completely. Then screw the adjustment screw into the pivot block as far as it will go.

Load the doors into the top track through the 150mm gap created in section 5, sliding them along till all doors are mounted as shown below, making sure they are loaded in the correct order to suit your configuration.

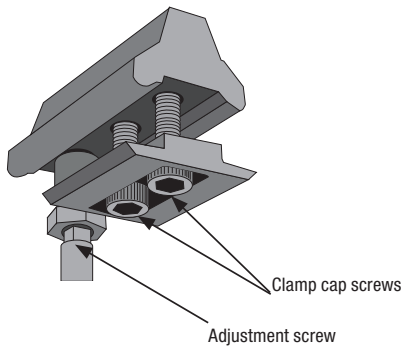

When loading the pivot door make sure the top pivot block(s) is facing the correct way. Some configurations (ie 3 left/1 right or 2 left/2 right) will have 2 pivot sets. When in the correct position the rear of the top pivot block should be flush with the rear of the bracket.

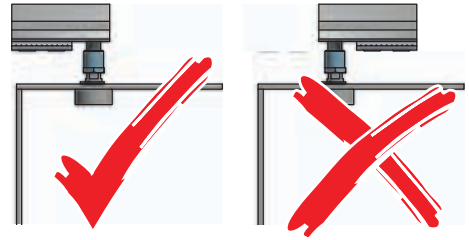

Typical configuration for 4 doors left or right shown

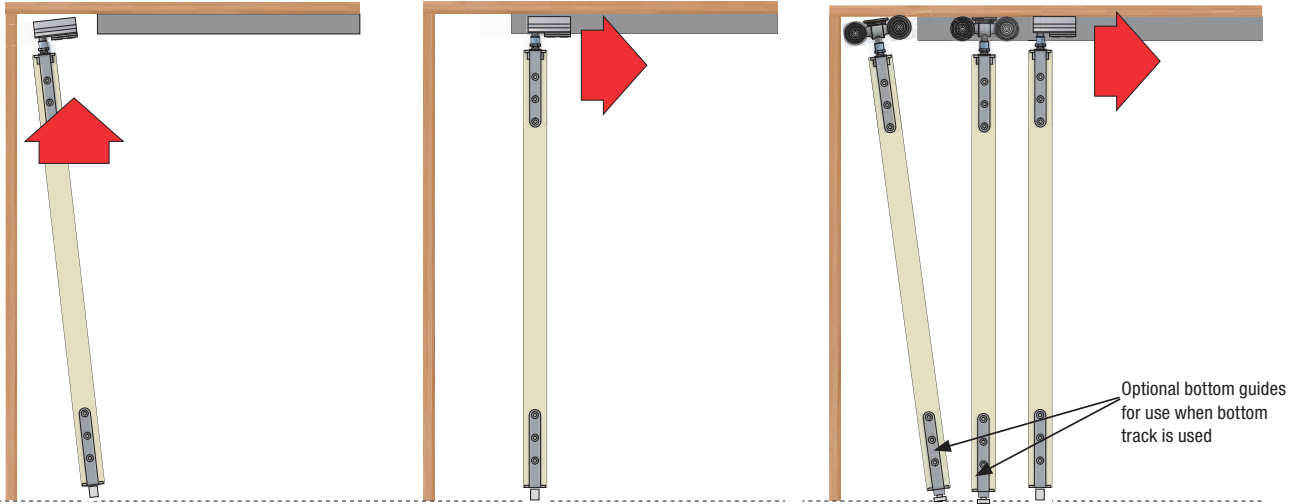

7 Pivot door(s)

Once all the doors have been mounted on the top track, the short (150mm) piece of top track should be fitted to the head in the gap as shown in section 5.

Next, slide the pivot set to its location at the end of the track and lift it upwards as high as possible to raise the bottom pivot above the floor level. Drop the bottom pivot into the bush previously inserted into the floor.

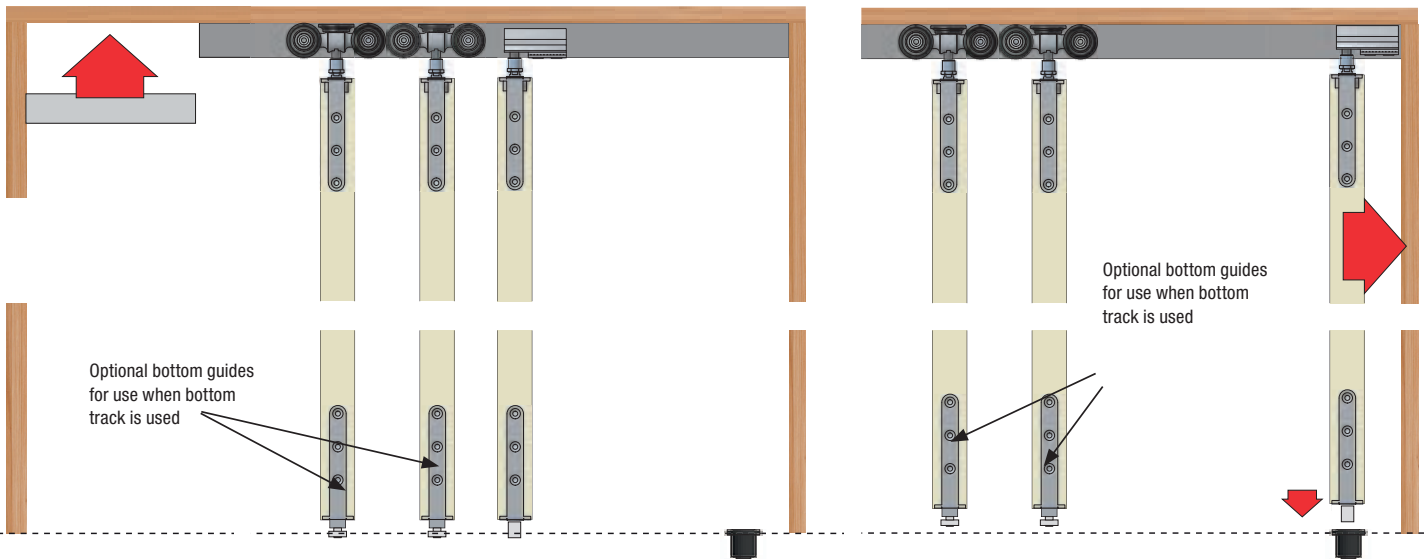

8 Pivot door(s) adjustment

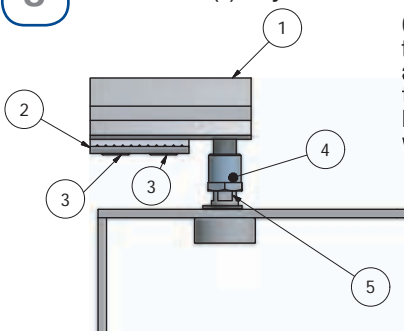

Once the pivot door is located in the bottom bush the door can be adjusted down slightly to achieve the correct door bottom gap (6mm) by turning the adjustment bolt (5) with the spanner supplied.

- Top Pivot Block (1)
- Clamp Plate (2)
- Clamp Cap Screws (3)
- Locking Nut (4)
- Adjustment bolt (5)

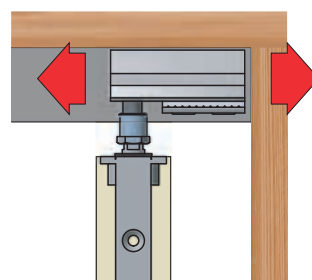

Adjust the pivot door plumb to the door jamb by moving the top pivot back or forth as required, then tighten the clamp cap screws (3) with a 5mm hex key to lock it in place. Check the bottom gap and re-adjust if necessary. When the pivot door is adjusted to the correct position the locking nut (4) should be tightened to lock the position.

9

Fitting the hinges

Attach the remaining doors by fitting the hinges as shown below.

The upper and lower hinges should be positioned 85mm from the top and bottom of the door, making sure there is an 16mm gap between doors when in the open position. The centre hinge should be positioned so the top of the hinge is approximately 1060mm from the bottom of the door.

DO NOT RECESS THE HINGES.

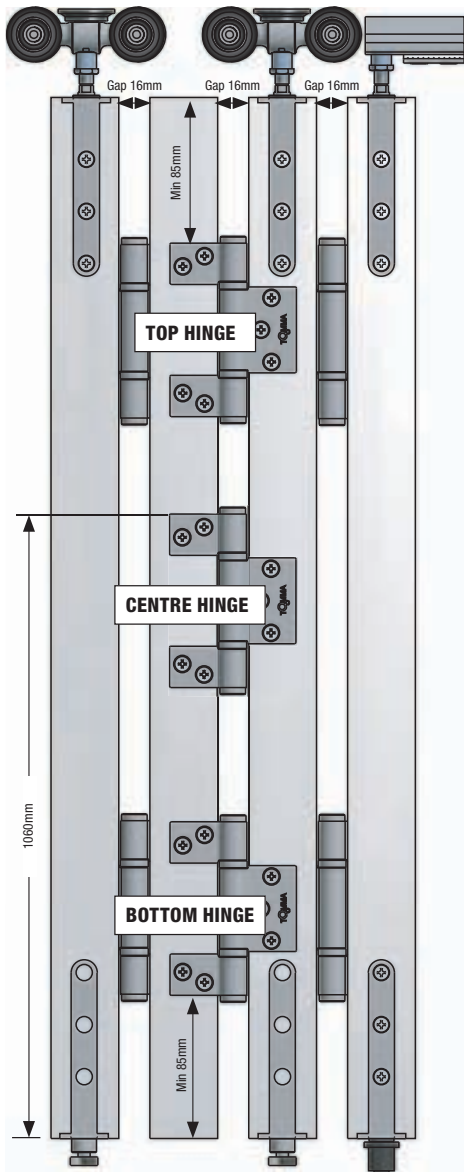

10

Door adjustment

Locking Nut (4)
Adjustment bolt (5)

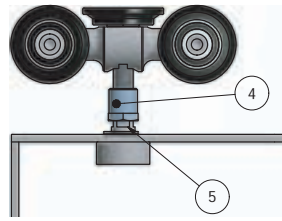

Adjust the height of the remaining doors by turning the adjustment bolt (5) with the spanner supplied. When the door is adjusted to the correct position the locking nut (4) should be tightened to lock the position.

11

Door bolts

Various options for flush bolts are shown below. Please refer to the one shown for your type of installation which is determined by door thickness and whether a bottom track is being used or not. Flush bolts should be recessed into doors.

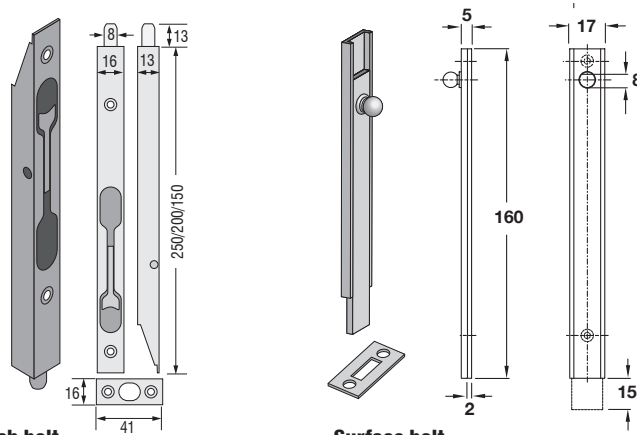

Flush bolt

Minimum width of door if used with bottom track = 45mm.

Surface bolt

Minimum width of door if used with bottom track = 35mm.

12

Fitting a stop

Due to outswing when sliding the doors open, a door stop cannot be fitted along the entire length of the frame head. It should be fitted above any 'free swinging' doors, ie those that do not have rollers

Examples

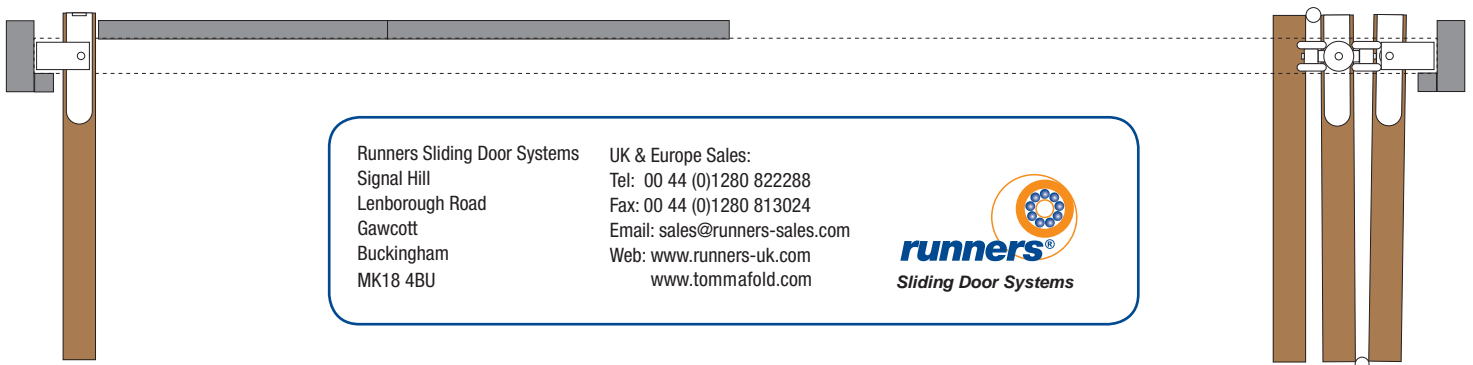
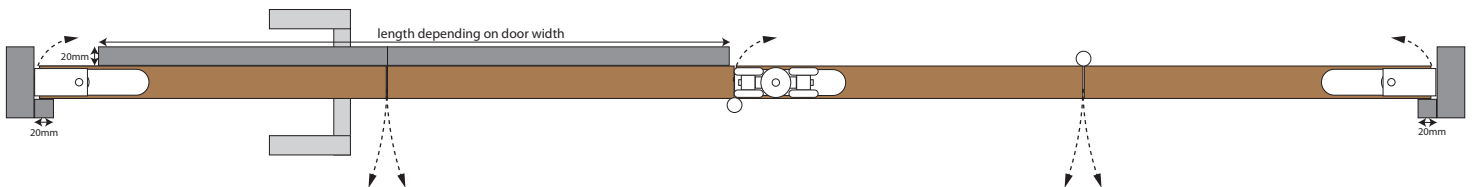
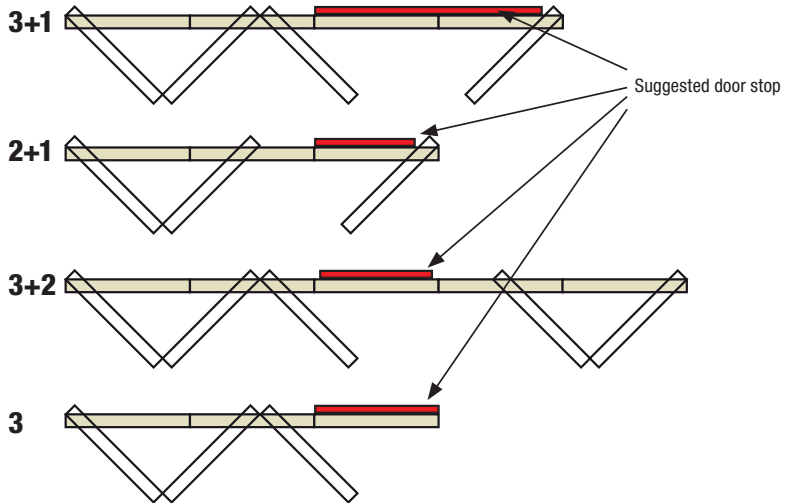

Runners Sliding Door Systems
Signal Hill
Lenborough Road
Gawcott
Buckingham
MK18 4BU

UK & Europe Sales:
Tel: 00 44 (0)1280 822288
Fax: 00 44 (0)1280 813024
Email: sales@runners-sales.com
Web: www.runners-uk.com
www.tommafold.com

