



KNAPP

Timber Construction
Connectors

from



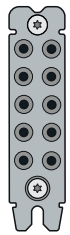

RICON
26 kN

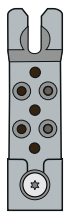

GIGANT
29.8 kN

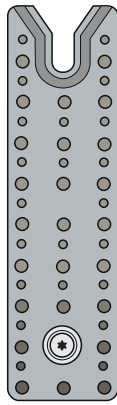

RICON S
100 kN

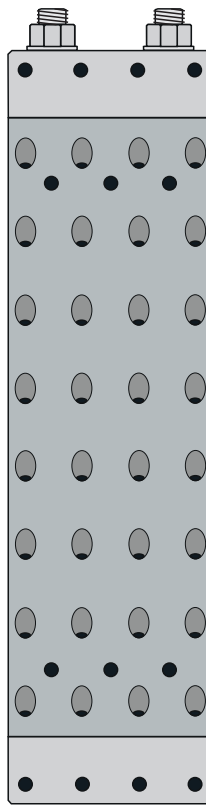

MEGANT
500 kN

**Incredible advances
in efficiency**

**Sustainable solution for
the construction industry**

**Allows for flexibility
in construction methods**

**Significant time savings compared to
on-site
construction methods**

**Improved factory
processes lead to high
quality products**

Prefabrication and modular construction is often commended for its energy efficiency and sustainable construction. One of the greatest advantages of prefabricated construction would be financial savings this is brought about by the significant time savings that can be made compared to a traditional on-site construction.

Since prefabricated construction occurs in a controlled manufacturing environment and follows specified standards, the sub-assemblies of the structure can be built to a consistently high, uniform quality.

Modular construction can be easily be disassembled and relocated to different sites. Having the advantage of being able to transport the assembled components also gives you flexibility in the design of the structure allowing for a limitless number of opportunities. Prefabricated construction is proving to be an extremely viable option, and as manufacturing technology continues to improve, expect to see its benefits and advantages rise in the future.





To find out more about the
Knapp connectors and to view
technical details visit
knappconnectors.com

Email Quest to subscribe to
the Knapp newsletter
knapp@qs-sales.com

Check out **Youtube** to see some
of their projects and capabilities of
Knapp Connectors

KNAPP Timber Construction Connectors



120x40
K051



150x40
K050



180x40
K052

- Highly loadable – in all directions
- Timber width from 60mm upwards
- Applications for porch, pergola, sun room and prefabricated house construction
- Self-tightening by permanent pressure
- Fire resistance (DIN 4102-2) by 4-sided concealed mounting ($R_{30} \geq 20$ mm, $R_{60} \geq 40$ mm)
- Optional locking clip – saves against the hooking direction (e.g. wind suction)
- Demounting and remounting possible for several times
- ETA additionally with hardwood material

Dovetail for easy positioning. The starting angle brings the connector into tension and offers an easy mounting



The clip lock offers an optional locking against direction of insertion



GIGANT

The connector for
main and secondary beam
up to **29.8 kN**

10mm KNAPP CS-screws with
cut point for extra fast screwing
and the reinforced shaft enables
a force-locked connection

GIGANT is made
of premium hot-dip blue
galvanised quality steel



KNAPP Timber Construction Connectors



RICON 60x40
K360

RICON 80x40
K361



RICON 100x40
K362

RICON 120x40
K363



RICON 140x40
K365

RICON 160x40
K364

The dove-tail stamping makes it very easy to catch the CS-screws and push together the connector. It also ensures tightness.

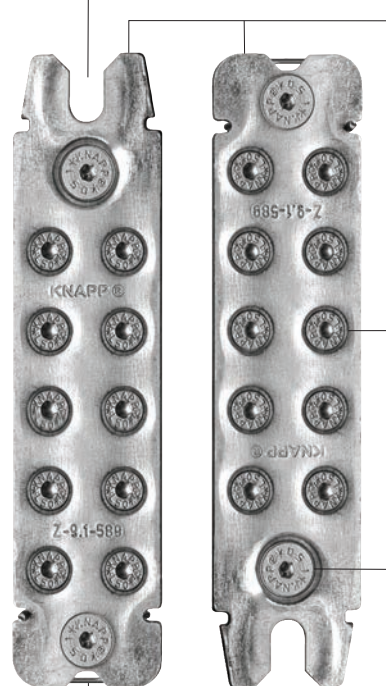

HEADER

JOINT

- Slim profile – timber width from 50 mm upwards
- Universal access to all wood materials, steel or concrete
- High degree of prefabrication – fast and exact mounting on-site
- Elements are joined together without screwing
- Adjustment of distance between joints and building tolerances
- Fire resistance (DIN 4102-2) by 4-sided concealed mounting
- Demounting and remounting possible for several times
- Increased resistance to corrosion for indoor swimming pools, riding halls, stables and agricultural buildings
- ETA now includes hardwood and softwood material

RICON consists of two identical parts. It is made of premium quality steel and is hot-dip galvanized and made in Austria.

Ø = 5 mm and Ø = 8 mm RICON CS-screws. These adjustable holding screws compensate fabrication tolerances. The reinforced shaft with integrated stop guarantees exact positioning.

Clip in the stainless spring steel stirrup into the locating slots prior to final assembly. It locks the connection against the slide-indirection and can be released again.

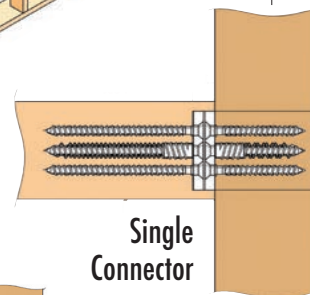
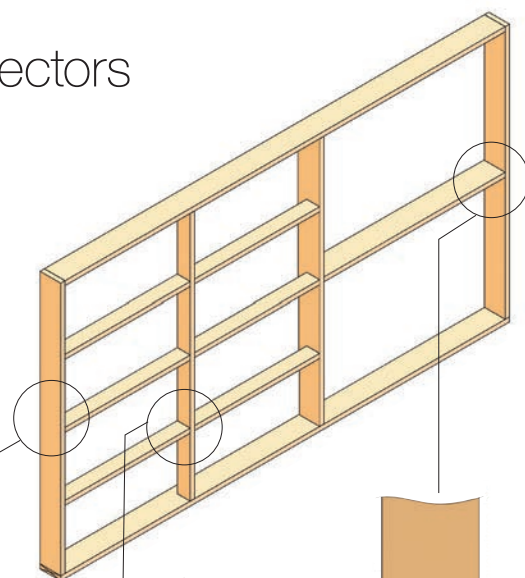

Single
Connector

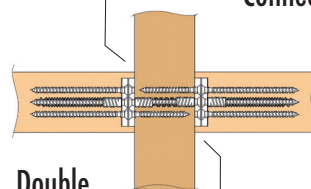

Double
Connector

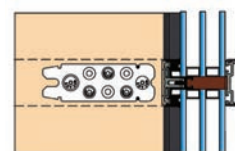
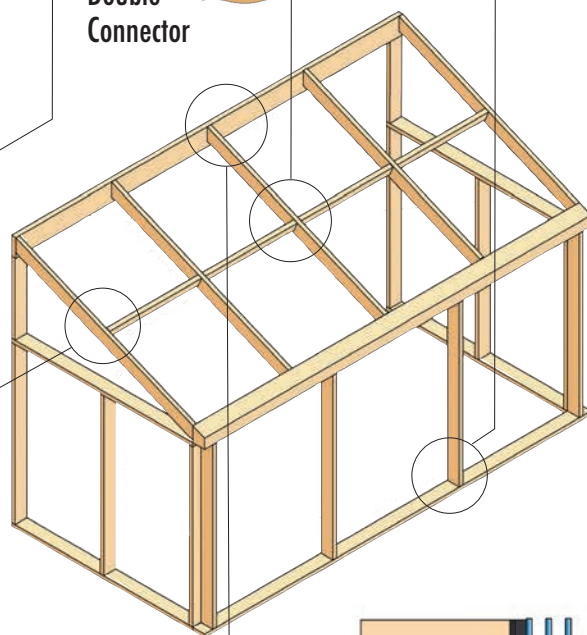

Typical use in
Glass Facade

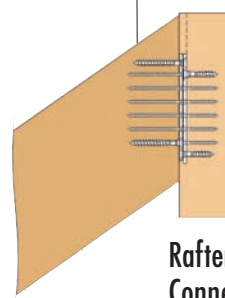

Rafter
Connection

RICON

The connector for
main and secondary beam
up to **26 kN**



KNAPP Timber Construction Connectors



RICON S
140x60x25
K126



RICON S
200x60x25
K127



RICON S
200x80x25
K128



RICON S
430x80x25
K129

- Connector for timber frame, wood frame buildings and halls
- Timber width from 100 mm upwards
- Universally applicable to timber, steel or concrete
- Simple screwing without predrilling
- Easy hooking by large V-shaping - only 3,5 cm hooking way
- High fire resistance through three - and four-sided concealed mounting
- Adjustable collar bolt up to 5mm length tolerance at full load capacity

Double Connector

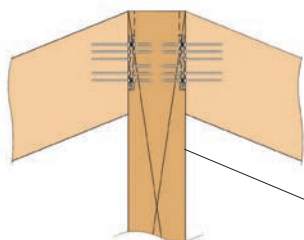
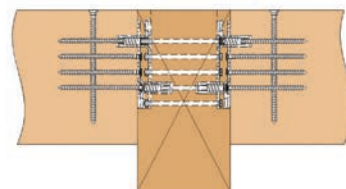

Rafter Construction

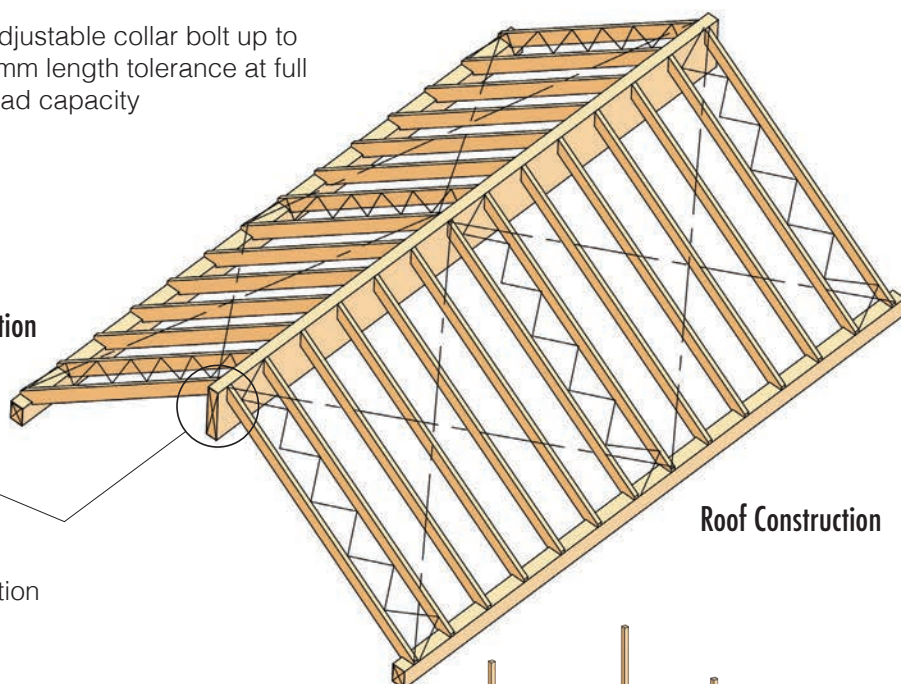

Roof Construction

The V-shape moulding provides perfect catch for the collar bolt. The strong tension and the short slide-in alleviates any connection problems and guarantees joint sealing



HEADER



JOINT

There are different versions of the collar bolt available for RICON S which offer four different options

KNAPP CS screws with cut point for extra fast starts and screwing. The reinforced shaft provides force-fit connections

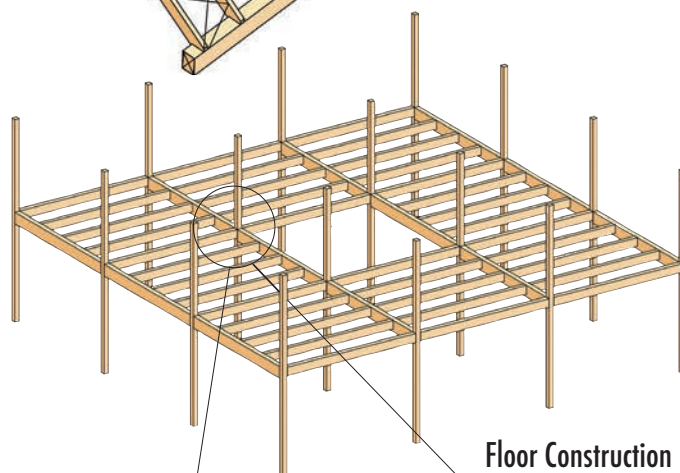

Floor Construction

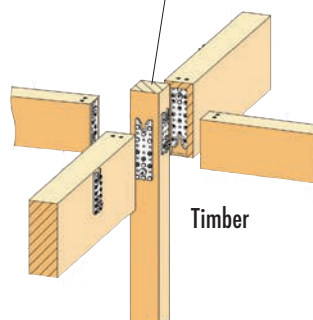

Timber

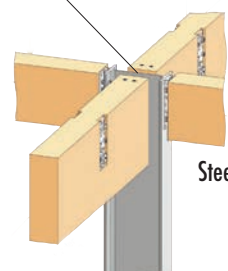

Steel



RICON S

The connector for
main and secondary beam
up to **100 kN**



The RICON S clip lock, made from stainless sprung steel, locks the connection against slide-in direction and can optionally be used for stress against slide-in direction and suction

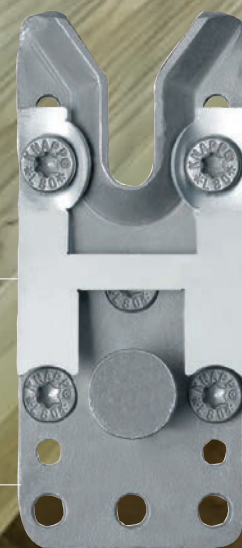

RICON S is made of premium hot-dip galvanised quality steel

KNAPP Timber Construction Connectors

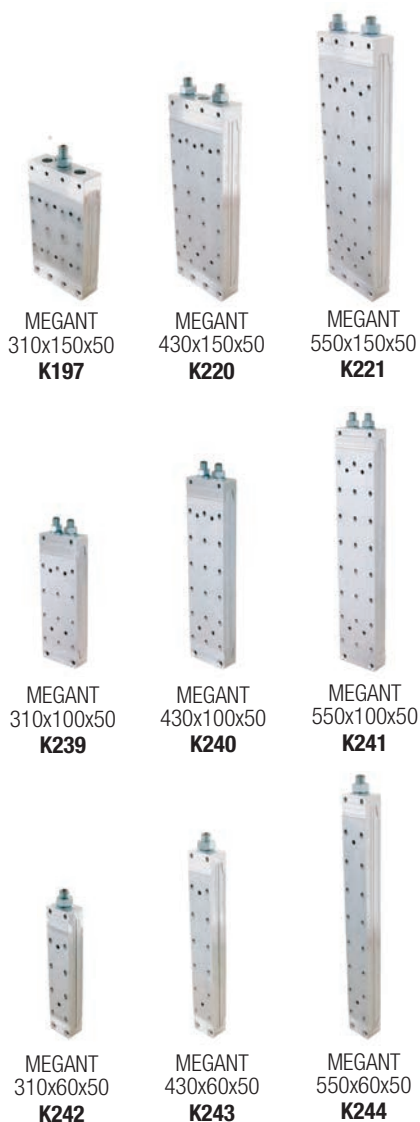

- Load range – standard sizes up to 428 kN, customized solutions up to 500 kN
- Minimum timber width $\leq 100 \text{ mm} - 190 \text{ mm}$
- Connection options – on wood, steel or concrete
- ETA-assessment for solid and glued laminated timber of soft and hardwood
- Additional wood materials like LVL, CLT, Parallam (PSL), Intrallam (LSL)
- MEGANT® ETA-assessment with stainless steel screws and threaded rods
- Unique – mounting possible from all directions without tilting
- Loadable in all directions
- Fire protection – three sided concealed jointless installation
- Short crane times by a high degree of prefabrication – only 2 cm hooking way
- Demountable

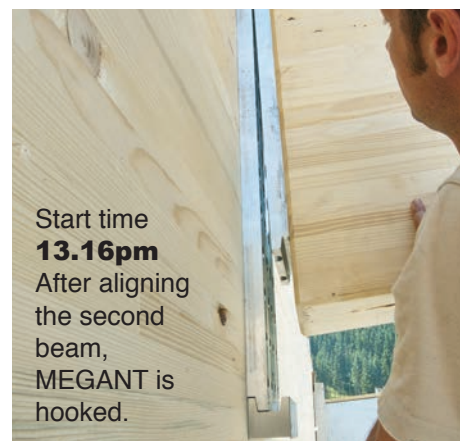
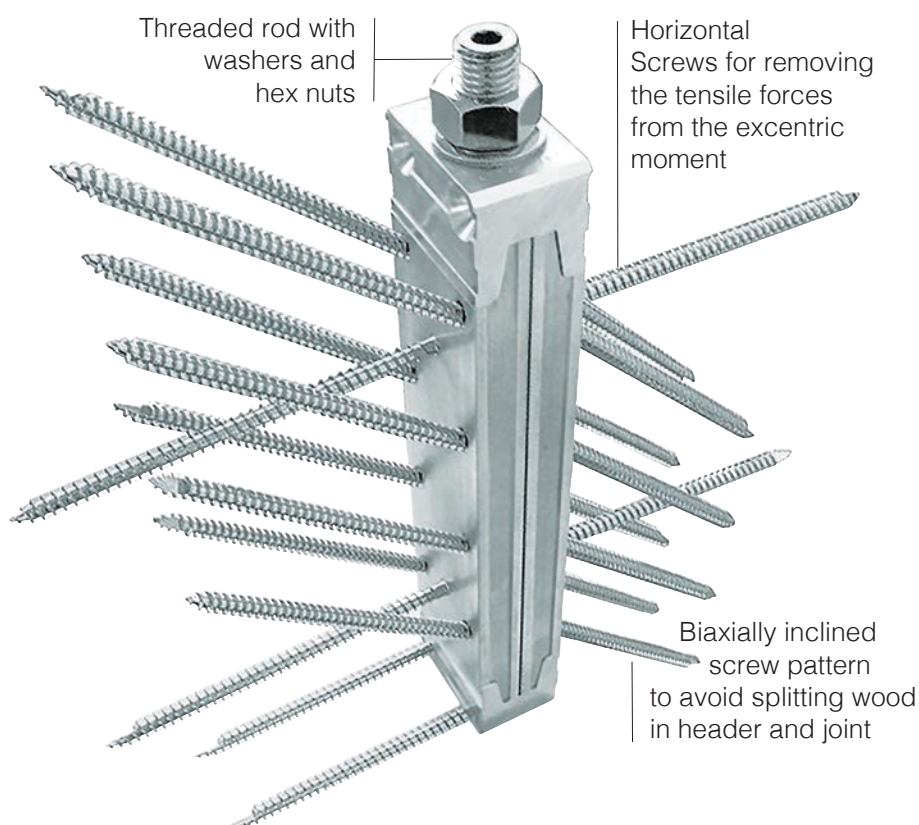

MEGANT

The heavy-duty
connector for timber
construction engineering
up to **500 kN**

Profiled base
plates made of alu-
minium with fasten-
ing holes
45° and 90°



Joist



Main Beam
(header)

Conical clamping
aluminium caps for closed
joints in the connection area.
Additional mounting holes for
easy installation and high
horizontal loads

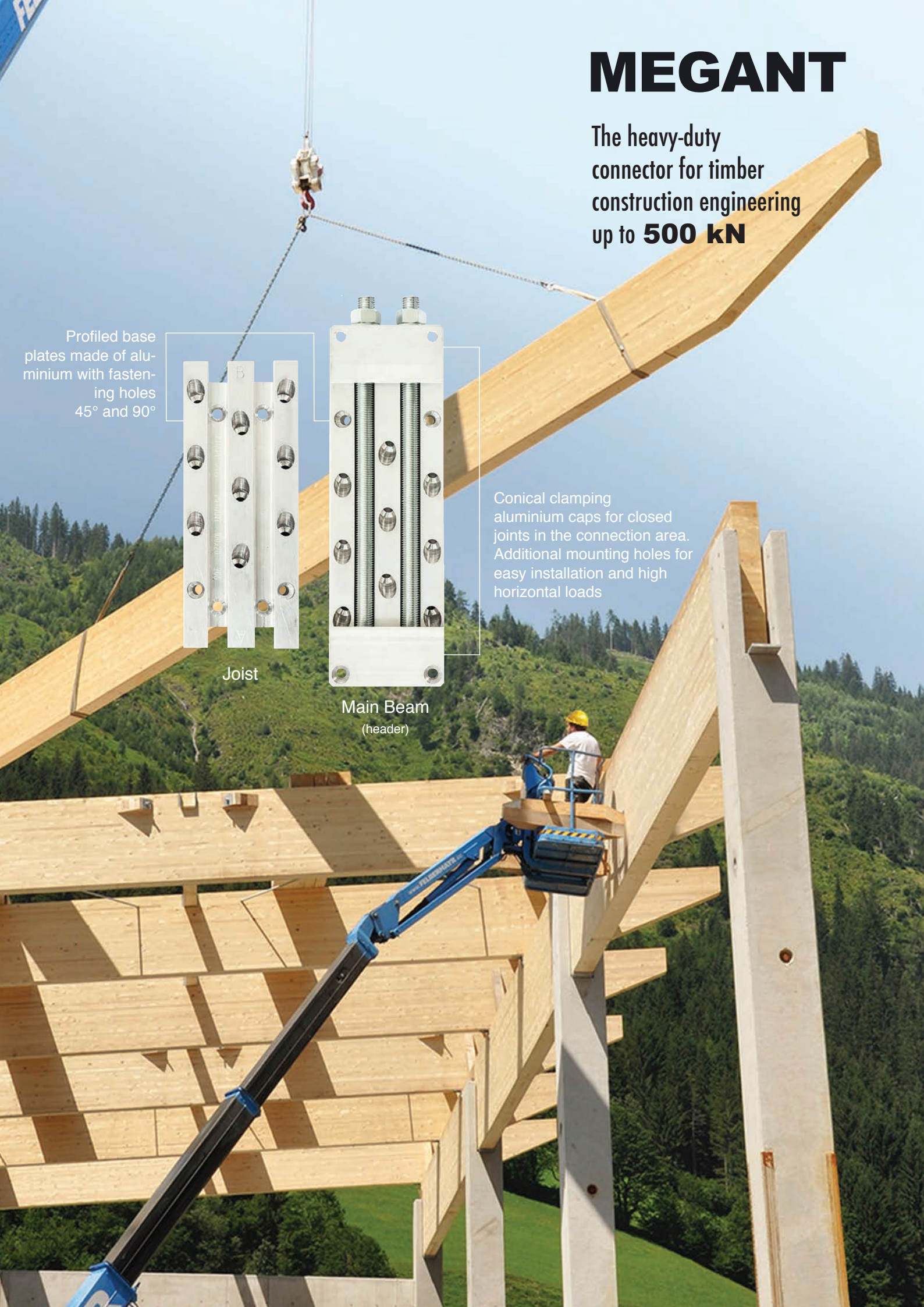

1 KFH100

RICON

KFH101 2

KFH102
KFH103
KFH104
KFH105
KFH106

3

1 TCT Slotting Cutters

Code	Cutter	Shank	Each
KFH100	Ø15mm x 25mm	Ø8mm	£21.00
KFH107	Ø15mm x 40mm	Ø12mm	£21.00

2 Routing Jigs

Code		Each
KFH101	RICON 40mm	£52.00
KFH114	RICON S 60mm	£61.00
KFH115	RICON S 80mm	£61.00
KFH101	GIGANT 40mm	£52.00

3 Drilling Jigs

RICON

Boring jig - integrated handle & stop
2 x fix bushes Ø5mm
2 x interchangeable bushes Ø5mm
2 x interchangeable bushes Ø10mm

Code		Each
KFH102	RICON 80/40	£179.00
KFH103	RICON 100/40	£179.00
KFH104	RICON 120/40	£179.00
KFH105	RICON 140/40	£179.00
KFH106	RICON 160/40	£179.00

GIGANT

Boring jig with bushes for Ø5mm drills
Adjustable handle stop
2 x Stop rail and Stop

Code		Each
KFH111	GIGANT 120/40	£139.00
KFH112	GIGANT 150/40	£149.00
KFH113	GIGANT 180/40	£169.00

4 RICON Mounting Set

Adjuster for RICON screws
RICON depth gauge
T25 Torx wrench, Allen key SW5

Code		Each
KFH116	Ricon 80/40	£13.90

1 KFH107

GIGANT

KFH101 2

KFH108
KFH109
KFH110

3

1 KFH107

RICON S

KFH114
KFH115 2

KFH116 4

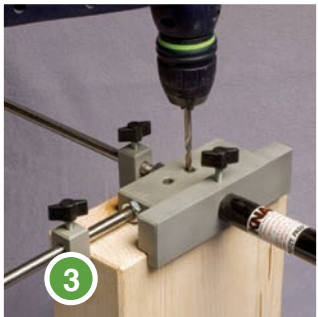



KNAPP

Timber Construction Connectors

Quest Hardware
Signal Hill
Lenborough Road
Gawcott
Buckingham
MK18 4BU

T 01280 822062
E sales@runners-sales.com
W runners-uk.com

from

